



# ENGINE BEARINGS

CTP Tri-Metal bearings (F780) are steel back bearings made of copper alloy, lead and tin with a nickel dam and finished with an electroplated Babbitt surface layer. The F780 alloy has a higher load carrying capacity than aluminum or other copper/lead alloy bearings. Tri-metal bearings can withstand up to 60% higher loads. As a result of this advance technology material, F780 will provide longer life in normal operation and significantly improved fatigue resistance under extreme operating conditions.

## MAIN BEARINGS

Part No.	Description	Engine	Application
1969531	MAIN BEARING	3512, 3516, 3516B, 3516C, 5230, 5230B, G3516, G3516B, G3516C, G3516E	785C, 789, 789B, 789C, 789D, 793C, 793D, 994, 994D, PM3516, PMG3516, PP3516
3932914	MAIN BEARING SET	C3.3B	236D, 242D, 246D, 257D, 259D, 262D, 277D, 279D, 287D, 289D, 308E, 308E CR, 308E SR, 308E2 CR, 906H2, 907H2, 908H2
5185431	MAIN BEARING SET	3054, C4.4	420E, 430E, 450E, CB-54B, CP-54, CS-54, TH336C, TH337C, TH414C, M313D, M315D
5185437	MAIN BEARING SET	3054, C4.4	420E, 430E, 450E, CB-54B, CP-54, CS-54, TH336C, TH337C, TH414C, M313D, M315D
0676886	MAIN BEARING SET	3054, 3054B,	206, 416C, 428C, CB-424, CP-433C, CS-323, CS-323C, CS-431C, PR-75, PS-110, PS-130, PS-180, TH210, TH215
1011530	MAIN BEARING	3114, 3116, 3126B, 3126E	120H, 120H ES, 120H NA, 135H, 135H NA, 320 L, 320B, 322B L, 322B LN, 325 LN, 325B L, 446B, 446D, 45, 561M, 613C II, 924F, 928F, 928G, 938F, 950F, 950F II, 953C, 960F, 963B
1070991	MAIN BEARING SET	3046	315, 315B, 315C, 317B LN, 318B, 933, 933C, 939, 939C, D3C III, D3G, D4C III, D4G, D5C III, D5G
1077708	MAIN BEARING	3114, 3116, 3126, 3126B, 3126E	120H, 120H ES, 120H NA, 120K, 120K 2, 12K, 12M, 135H, 135H NA, 140G, 140K, 140K 2, 140M, 160K, 214B, 30/30, 320 L, 320B, 322B L, 322B LN, 322C, 322C FM, 324D, 324D FM
1280383	MAIN BEARING	3176C, 3196	140H, 143H, 14H, 14M, 160H, 163H, 16H, 16M, 345B, 345B II, 345B II MH, 345B L, 345C, 345C L, 345C MH, 345D, 345D L, 345D L VG, 349D, 349D L, 349E, 349E L, 349E L HVG, 349E L VG, 349F L

\*\* (ARRIVING EARLY 2022)

\* Other part no. not included in the list are available. Please contact your sales representative if you have any questions. Part Numbers are used for reference purposes only.

## MAIN BEARINGS - Con't.

Part No.	Description	Engine	Application
1467808	MAIN BEARING SET	3014, 3024, 3024C, C2.2	216, 216B, 226B, 232B, 242B, 247B, 257B, 304.5, 902, CB-334D, CB-334E, CB-335D
1496031	MAIN BEARING	3508, 3508B, 3508C, 3512, 3512B, 3512C, 3516, 3516B, 3516C	5130, 5130B, 5230, 5230B, 776C, 776D, 777, 777B, 777C, 777D, 784C, 785, 785B, 785C, 785D, 789, 789B, 789C, 789D, 793C, 793D, 797, 797B, 854G
1512939	MAIN BEARING	C9	12H, 12M 2, 12M 3, 12M 3 AWD, 140M, 140M 2, 140M 3, 140M 3 AWD, 160M, 160M 2, 160M 3, 160M 3 AWD, 2290, 2390, 2391, 2491, 2590, 2864C, 330C, 330C FM, 330C L, 330C MH, 330D, 330D FM, 330D L, 330D LN
1526791	MAIN BEARING SET	3034	216, 228, 236, 247, 248, 267, 287, 906
1541203	MAIN BEARING SET	3014, 3024, 3024C	216, 216B, 226B, 232B, 242B, 247B, 257B, 304.5, 902, C2.2, CB-334D, CB-334E, CB-335D
1566977	MAIN BEARING SET	3013, 3013C, C1.1, C1.5, C2.2	302.5, 303.5, CB-214D, CB-214E, CB-22, CB-334D, CB-334E, CB-335D, CB-34, CB22B, CB24B, CB32B, CC24B
1969516	MAIN BEARING SET	3114	CB-434
1969519	MAIN BEARING	3116, 3126, 3126B, 3126E	120H, 120H ES, 120H NA, 120K, 120K 2, 12K, 12M, 135H, 135H NA, 140G, 140K, 140K 2, 140M, 160K, 214B, 30/30, 320B, 322B L, 322B LN, 322C, 322C FM, 324D, 324D FM, 324D FM LL
1969530	MAIN BEARING SET	3512, 3512B, 3512C, G3512, G3512B, G3512E	777D, 784C, 785, 785B, 785C, 785D, 797, 797B, PM3512, SPF343, SPF343C, SPS343, SPT343, TH48-E80, TH55-E70
1969534	MAIN BEARING SET	3306, 3306B, 3306C	12H, 12H ES, 12H NA, 140G, 140H, 140H ES, 140H NA, 143H, 14H NA, 160H, 160H ES, 160H NA, 163H NA, 235B, 330, 330B L, 350, 545, 572R, 611, 615C, 627B, 627F, 627G, 637E, 637G, 65C
1H1544	MAIN BEARING (FRONT)	D315	955C, 977D, D315
1H1545	MAIN BEARING (INTER)	D315	955C, 977D, D315
1H1546	MAIN BEARING (CENTER)	D315	955C, 977D, D315
1H1547	MAIN BEARING (REAR)	D315	955C, 977D, D315
1N4316	MAIN BEARING (FRONT)	D353	D9H
1N4317	MAIN BEARING (INTER)	D353	D9H
1N4318	MAIN BEARING (CENTER)	D353	D9H
1N4331	MAIN BEARING (REAR)	D353	D9H
1W0311	MAIN BEARING	3204	215, 916, 926, 931B, 943, 953, D4HTSK II
1W0312	MAIN BEARING	3204	215, 916, 926, 931B, 943, 953, D4HTSK II
2110587	MAIN BEARING	3176C, 3196	140H, 143H, 14H, 14M, 160H, 163H, 16H, 16M, 345B, 345B II, 345B II MH, 345B L, 345C, 345C L, 345C MH, 345D, 345D L, 345D L VG, 349D, 349D L, 349E, 349E L, 349E L HVG, 349E L VG, 349F L
2110588	MAIN BEARING	3176C, 3196	140H, 143H, 14H, 14M, 160H, 163H, 16H, 16M, 345B, 345B II, 345B II MH, 345B L, 345C, 345C L, 345C MH, 345D, 345D L, 345D L VG, 349D, 349D L, 349E, 349E L, 349E L HVG, 349E L VG, 349F L
2170390	MAIN BEARING	3408, 3412C	TRUCK
2323233	MAIN BEARING	3304, 3304B, 3306, 3306B, 3306C	120G, 12G, 12H, 12H ES, 12H NA, 130G, 140G, 140H, 140H ES, 140H NA, 143H, 14G, 14H NA, 160G, 160H, 160H ES, 160H NA, 163H NA, 1673C, 235, 235B, 330
2335486	MAIN BEARING	C3.4	236B, 236B3, 242B3, 246C, 252B, 252B3, 256C, 257B3, 259B3, 262C, 262C2, 267B, 268B, 272C, 277C, 277C2, 279C, 279C2, 287C, 287C2, 289C, 289C2, 297C, 299C, 3044C, 906, 906H, 907H, 908H

\*\* (ARRIVING EARLY 2022)

\* Other part no. not included in the list are available. Please contact your sales representative if you have any questions. Part Numbers are used for reference purposes only.

# MAIN BEARINGS - Con't.

Part No.	Description	Engine	Application
2436716	MAIN BEARING SET	C9	12H, 12M 2, 12M 3, 12M 3 AWD, 140M, 140M 2, 140M 3, 140M 3 AWD, 160M, 160M 2, 160M 3, 160M 3 AWD, 2290, 2390, 2391, 2491, 2590, 2864C, 330C, 330C FM, 330C L, 330C MH, 330D, 330D FM, 330D L, 330D LN
2436717	MAIN BEARING SET	C10, C12	14M, 16M, 345C, 345C L, 345C MH, 345D, 345D L, 345D L VG, 349D, 349D L, 349E, 349E L, 349E L HVG, 349E L VG, 349F L, 621H, 621K, 623H, 623K, 623K LRC, 627H, 627K, 627K LRC, 725, 730, 730C, 966H, 972H
2436718	MAIN BEARING SET	3406, 3406B, 3406C, 3406E, 3412, 3412C, 3412D, 3412E, 3456	16G, 16H NA, 24H, 24M, 365C, 365C L, 365C L MH, 374D L, 374F L, 375 L, 385B, 385C, 385C FS, 385C L, 385C L MH, 390D, 390D L, 390F L, 5080
3178766	MAIN BEARING	3406, 3406B, 3406C, 3406E, 3408, 3408B, 3408C, 3408E, 3412, 3412C, 3412D, 3412E, 3456	16G, 16H NA, 24H, 24M, 365C, 365C L, 365C L MH, 374D L, 374F L, 375, 375 L, 385B, 385C, 385C FS, 385C L, 385C L M
3215746	MAIN BEARING	G3406, G3408, G3408B, G3408C, G3412, G3412C	583R, CG137-08, CG137-12, D8R, D8R II,
3537415	MAIN BEARING SET	3056, 3056E	924G, 924GZ, 930G, AP-655C, BB-760, CP-573E, CP-663E, CS-563E, CS-583E, CS-663E, CS-683E, IT28G, M316C, M318C, M318C MH, M322C
3537427	MAIN BEARING SET	3054, 3054B	206, 212, 307, 312, 312B L, 312C, 315, 315B L, 317, 416B, 416C, 416D, 420D, 426B, 426C, 428, 428B, 428C, 430D, 436C, 438C, 554, 908, 914G, AP-800C, BG-225C, CB-424, CB-434B, CB-434C, CB-5
3601978	MAIN BEARING SET	C6.6	120M, 120M 2, 12M, 2384C, 2470C, 2484C, 2570C, 2670C, 320D GC, 320D L, 320D2, 320D2 GC, 320D2 L, 320E, 320E L, 320E LN, 320E LRR, 320E RR, 323D L, 323D2 L, 323E L, 324E, 324E L, 324E LN, 329E, 329E L
4F1724	MAIN BEARING (FRONT)	D315	120M, 120M 2, 12M, 2384C, 2470C, 2484C, 2570C, 2670C, 320D GC, 320D L, 320D2, 320D2 GC, 320D2 L, 320E, 320E L, 320E LN, 320E LRR, 320E RR, 323D L, 323D2 L, 323E L, 324E, 324E L, 324E LN, 329E, 329E L
4F1725	MAIN BEARING (INTER)	D315	INDUSTRIAL
4F1726	MAIN BEARING (CENTER)	D315	INDUSTRIAL
4F1727	MAIN BEARING (REAR)	D315	INDUSTRIAL
4H5510	MAIN BEARING (CENTER/REAR)	D342, D342C	583H, D8H
4H5511	MAIN BEARING	D342	583, D8
4W5488	MAIN BEARING	D348	777
4W5689	MAIN BEARING	D348	777
4W8092	MAIN BEARING	3208	613C, PR-1000, PS-500
4W8093	MAIN BEARING	3208	613C, PR-1000, PS-500
5I7588	MAIN BEARING SET	3064, 3066	311, 311B, 311C, 311D LRR, 312, 312B, 312C, 312C L, 312D, 312D L, 313D, 314C, 314D CR, 314D LCR, 315D L, 318C, 318D L, 319C, 319D, 319D L, 319D LN, 320, 320 L, 320B, 320C, 320C FM, 320C L, 320D, 320D
6136-21-8010 **	MAIN BEARING KOMATSU®	4D105, 6D105, S4D105, S6D105, SA6D110	INDUSTRIAL
6150-21-8010	MAIN BEARING KOMATSU®	6D125, 6D125E, SAA6D125E	INDUSTRIAL
6204-21-8100	MAIN BEARING KOMATSU®	3D95S, 4D95L, 4D95LE, 4D95S, SAA4D95LE	INDUSTRIAL
6210-21-8010 **	MAIN BEARING KOMATSU®	S6D140, S6D140E, SA6D132, SA6D140, SA6D140A, SA6D140E, SAA6D140E	WA500, EGS500, EGS570, EGS630, HM350, HM400

\*\* (ARRIVING EARLY 2022)

\* Other part no. not included in the list are available. Please contact your sales representative if you have any questions. Part Numbers are used for reference purposes only.

## MAIN BEARINGS - Con't.

Part No.	Description	Engine	Application
6754-22-8100	MAIN BEARING KOMATSU®	SA6102-1AC, SAA6D107E,	PC240, PC290, WA250PZ, WA320, WA320PZ
6F1931	MAIN BEARING (FRONT)	D342, D342C	583H, D8H
6F1932	MAIN BEARING (INTER)	D399	D8
6F1933	MAIN BEARING (CENTER)	D399	D8
6H4510	MAIN BEARING (REAR)	D342, D342C	583H, D8H
7S9439	MAIN BEARING	D333A, D334	12E, 1673, 1674, 955K, 977H
7W2138	MAIN BEARING	D343, G343	825B, 16, 168B, 169, 169B, 983, 824B, 834, 631C, 633C, 637, 657, 666B
7W4107	MAIN BEARING	3176, 3176B	75, 75C, 85C, R1700 II
8F3852	MAIN BEARING	D326F, D337, D337F, D342, D342C, D353C, D375D, D379, D397D	657
8N6652	MAIN BEARING	D346, D348, D349	651, 657B, 992
8N7764	MAIN BEARING	D379B, D398, D398A, D398B, D399, G398, G399	INDUSTRIAL
8N7765	MAIN BEARING	D379B, D398, D398A, D398B, D399, G398, G399	INDUSTRIAL
8N7923	MAIN BEARING (INTER)	D379, D398, D399	D7E
9M3894	MAIN BEARING	D353C	D9G
9M3895	MAIN BEARING	D353C	D9G
9Y4033	MAIN BEARING	3176, 3176B	75, 75C, 85C, R1700 II
8N7764	MAIN BEARING	D379B, D398, D398A, D398B, D399, G398, G399	INDUSTRIAL
8N7765	MAIN BEARING	D379B, D398, D398A, D398B, D399, G398, G399	INDUSTRIAL
8N7923	MAIN BEARING (INTER)	D379, D398, D399	D7E
9M3894	MAIN BEARING	D353C	D9G
9M3895	MAIN BEARING	D353C	D9G
9Y4033	MAIN BEARING	3176, 3176B	75, 75C, 85C, R1700 II

## CRANKSHAFT THRUST PLATE / WASHER

Part No.	Description	Engine	Application
9S1162	BEARING THRUST	D346, D348, D349	641B, 650B, 657B, 666B, 772, 773, 777, 992, D10
7C3195	BLOCK-THRUST	3054, 3054B	206, 212, 312B L, 312C, 416B, 416C, 416D, 420D, 424D, 426C, 428, 428B, 428C, 428D, 430D, 432D, 436C, 438C, 438D, 442D, 554, 908, 914G, AP-800, CB-424, CB-434B, CB-434C, CB-535B, CB-544
9S3037	PLATE-THRUST	1673C, 3304, 3306	225, 627, 955K
1039288	PLATE-THRUST	C3.4	236B, 236B3, 242B3, 246C, 252B, 252B3, 256C, 257B3, 259B3, 262C, 262C2, 267B, 268B, 272C, 277C, 277C2, 279C, 279C2, 287C, 287C2, 289C, 289C2, 297C, 299C, 3044C, 315, 315B, 315C, 317B LN, 318B, 906
1105138	PLATE-THRUST	3176, 3176B	75, 75C, 85C

\*\* (ARRIVING EARLY 2022)

\* Other part no. not included in the list are available. Please contact your sales representative if you have any questions. Part Numbers are used for reference purposes only.

## CRANKSHAFT THRUST PLATE / WASHER - *Con't.*

Part No.	Description	Engine	Application
2463144	PLATE-THRUST	3176C, 3196	140H, 143H, 14H, 14M, 160H, 163H, 16H, 16M, 345B, 345B II, 345B II MH, 345B L, 345C, 345C L, 345C MH, 345D, 345D L, 345D L VG, 349D, 349D L, 349E, 349E L, 349E L HVG, 349E L VG, 349F L
2463150	PLATE-THRUST	C7.2, C9	12H, 12M 2, 12M 3, 12M 3 AWD, 140M, 140M 2, 140M 3, 140M 3 AWD, 160M, 160M 2, 160M 3, 160M 3 AWD, 2290, 2390, 2391, 2491, 2590, 2864C, 330C, 330C FM, 330C L, 330C MH, 330D, 330D FM, 330D L, 330D LN
2531752	PLATE-THRUST	3406, 3406B, 3406C, 3406E, 3408, 3408B, 3408C, 3408E, 3412, 3412C, 3412D, 3412E, 3456	16G, 16H NA, 24H, 24M, 365C, 365C L, 365C L MH, 374D L, 374F L, 375, 375 L, 385B, 385C, 385C FS, 385C L, 385C L M
1W1174	PLATE-THRUST	3606, 3608, 3612, 3616, G3606, G3608, G3612, G3616	GENERATOR, INDUSTRIAL, MARINE
4L4653	PLATE-THRUST	D379A, D379B, D398A, D398B, D399, G379, G398, G399	GENERATOR, INDUSTRIAL, MARINE
5I7654	PLATE-THRUST	3066	311, 311B, 311C, 311D LRR, 312, 312B, 312C, 312C L, 312D, 312D L, 313D, 314C, 314D CR, 314D LCR, 315D L, 318C, 318D L, 319C, 319D, 319D L, 319D LN, 320, 320 L, 320B, 320C, 320C FM, 320C L, 320D, 320D
6N8940	PLATE-THRUST	3304, 3306, G3306	120B, 12G, 140B, 910, 930, 931B, 955K, D3, D4D, D5, D7F, D7G
7C6209	PLATE-THRUST	3508, 3508B, 3508C, 3512, 3512B, 3512C, 3516, 3516B, 3516C, 5130, 5130B, 5230, 5230B	776C, 776D, 777, 777B, 777C, 777D, 784B, 784C, 785, 785B, 785C, 785D, 789, 789B, 789C, 789D, 793B, 793C, 793D, 797
6150-21-8050	THRUST METAL KOMATSU®	6D125, 6D125E, SAA6D125E	INDUSTRIAL
7N9343	THRUST PLATE	3304, 3306, G3306	120G, 12G, 130G, 140G, 14G, 1673C, 235, 3304, 3306, 518, 528, 561D, 571G, 572G, 615, 627B, 637D, 639D, 814B, 815, 816, 816B, 920, 930, 930R, 941, 950, 950B, 950B/950E, 951B, 955L, 966C, 966D, 977L, D4
1526799	WASHER-THRUST	3034	216, 228, 236, 247, 248, 267, 287, 906
1541230	WASHER-THRUST	3014, 3024, 3024C, C1.5, C2.2	216, 216B, 216B3, 226B, 226B3, 232B, 242B, 247B, 247B3, 257B, 304.5, 902, AP-255E, BB-621C, CB-334D, CB-334E, CB-335D, CB-34, CB34B, CB34B XW, CC34B
1541231	WASHER-THRUST	3013, 3013C, 3014, 302.5, 3024, 3024C, C1.1, C1.5, C2.2	216, 216B, 216B3, 226B, 226B3, 232B, 242B, 247B, 247B3, 257B, 302.5, 3024, 3024C, 303.5, 304.5, 902, AP-255E, BB-621C, CB-214D, CB-214E, CB-22, CB-334D, CB-334E
0676873	WASHER-THRUST	3054, 3054B, 3054C, 3054E, 3056, 3056E	206, 212, 214, 224, 307, 312, 312B L, 312C, 312D2, 312D2 GC, 312D2 L, 313D2, 313D2 LGP, 315, 315B L, 315C, 317, 318D2 L, 414E, 416B, 416C, 416D, 416E, 416F
2W1577	WASHER-THRUST	3204	215, 943, 953, D4HTSK II
2124893	MAIN BEARING (THRUST)	3114, 3116, 3126, 3126B, 3126E,	120H, 120H ES, 120H NA, 120K, 120K 2, 12K, 12M, 135H, 135H NA, 140G, 140K, 140K 2, 140M, 160K, 214B, 30/30, 320B, 322B L, 322B LN, 322C, 322C FM, 324D, 324D FM, 324D FM
2295155	MAIN BEARING (THRUST)	3114, 3116, 3126, 3126B, 3126E	120H, 120H ES, 120H NA, 120K, 120K 2, 12K, 12M, 135H, 135H NA, 140G, 140K, 140K 2, 140M, 160K, 214B, 30/30, 320B, 322B L, 322B LN, 322C, 322C FM, 324D, 324D FM, 324D FM
2295156	MAIN BEARING (THRUST)	3114, 3116, 3126, 3126B, 3126E	120H, 120H ES, 120H NA, 120K, 120K 2, 12K, 12M, 135H, 135H NA, 140G, 140K, 140K 2, 140M, 160K, 214B, 30/30, 320B, 322B L, 322B LN, 322C, 322C FM, 324D, 324D FM, 324D FM
4W8091	MAIN BEARING (THRUST)	3208	613C, PR-1000, PS-500
6204-21-8500	MAIN BEARING (THRUST) (3 PIECES)	3D95S, 4D95L, 6D95L	
7W2137	MAIN BEARING (THRUST)	D343, G343	825B, 16, 168B, 169, 169B, 983, 824B, 834, 631C, 633C, 637, 657, 666B

\*\* (ARRIVING EARLY 2022)

\* Other part no. not included in the list are available. Please contact your sales representative if you have any questions. Part Numbers are used for reference purposes only.

# CONNECTING ROD BEARINGS

Part No.	Description	Engine	Application
2697290	CONNECTING ROD BEARING	C13	12M 2, 12M 3, 12M 3 AWD, 140M 2, 140M 3, 140M 3 AWD, 160M 2, 160M 3, 160M 3 AWD, 2864C, 336E, 336E H, 336E HVG, 336E L, 336E LH, 336E LN, 336F L, 568 FM LL, 586C, 627H, 627K, 627K LRC, 725C, 966K
3887500	CONNECTING ROD BEARING	STD	C3.3B
1039683	CONNECTING ROD BEARING	3046	315, 315B, 315C, 317B LN, 318B, 933, 933C, 939, 939C, D3C III, D3G, D4C III, D4G, D5C III, D5G
1077330	CONNECTING ROD BEARING	3508, 3508B, 3508C, 3512, 3512B, 3512C, 3516, 3516B, 3516C	5130, 5130B, 5230, 5230B, 776C, 776D, 777, 777B, 777C, 777D, 784B, 784C, 785, 785B, 785C, 789, 789B, 789C, 789D, 793B, 793C, 793D, 797, 797B
1077334	CONNECTING ROD BEARING	3508, 3508B, 3508C, 3512, 3512B, 3512C, 3516, 3516B, 3516C	5130, 5130B, 5230, 5230B, 776C, 776D, 777, 777B, 777C, 777D, 784B, 784C, 785, 785B, 785C, 789, 789B, 789C, 789D, 793B, 793C, 793D, 797, 797B
1152972	CONNECTING ROD BEARING	C10, C12	14M, 16H, 16M, 345C, 345C L, 345C MH, 345D, 345D L, 345D L VG, 349D, 349D L, 349E, 349E L, 349E L HVG, 349E L VG, 349F L, 365B, 365B II, 365B L, 621H, 621K, 623H, 623K, 623K LRC, 627H, 627K, 627K LRC
1161089	CONNECTING ROD BEARING	3176B, 3176C, 3196	14M, 16M, 345C, 345C L, 345C MH, 345D L, 725, 730, 85D, 85E, 95E, 966H, 972G II, 972H, C-12, C11, C12, C13, CX31-C13I, D8N, MTC835, RM-300, TH35-C11I, TH35-C13I, TH35-C13T, W345C M
1N4336	CONNECTING ROD BEARING	D353	D9H
1W8539	CONNECTING ROD BEARING	D346, D348, D349	777
2133190	CONNECTING ROD BEARING	C9	12H, 140M, 140M 2, 160M, 160M 2, 2290, 2390, 2391, 2491, 2590, 330C, 330C FM, 330C L, 330C MH, 330D, 330D FM, 330D L, 330D LN, 330D MH, 336D, 336D L, 336D LN, 336D2, 336D2 L, 340D L, 340D2 L, 511, 521
2170577	CONNECTING ROD BEARING	C-10	140H, 143H, 14H, 160H, 163H, 3176C, 345B, 345B II, 345B II MH, 345B L, 572R II, 65E, 725, 75D, 75E, 814F, 815F, 816F, 966G II, CPT372, D7R II, R1600, R1600G, R1700G, TK1051, W345B II
2170578	CONNECTING ROD BEARING	3406B, 3406E	980G, 980G II, D350E II, D400E II
2243246	CONNECTING ROD BEARING	3406E, C15, C18	24M, 365C, 365C L, 365C L MH, 374D L, 374F L, 385C, 385C FS, 385C L, 385C L MH, 390D, 390D L, 583T, 587T, 621B, 621F, 621G, 621H, 623E, 623F, 623G, 623H, 627F, 627G, 627H, 631D, 631E, 631G, 633E II
2246638	CONNECTING ROD BEARING	3114, 3116, 3126, 3126B, 3126E	120H, 120H ES, 120H NA, 120K, 120K 2, 12K, 12M, 135H, 135H NA, 140G, 140K, 140K 2, 140M, 160K, 30/30, 320B, 322B L, 322B LN, 322C, 322C FM, 324D, 324D FM, 324D FM LL
2296259	CONNECTING ROD BEARING	C15	24M, 3412D, 365C, 365C L, 365C L MH, 374D L, 374F L, 385C, 385C FS, 385C L, 385C L MH, 390D, 390D L, 390F L, 583T, 587T, 621B, 621G, 623G, 627F, 627G, 631D, 631E, 631G, 633E II, 637D, 637E, 637G, 651B.
2302520	CONNECTING ROD BEARING	3512C	24M, 3412D, 365C, 365C L, 365C L MH, 374D L, 374F L, 385C, 385C FS, 385C L, 385C L MH, 390D, 390D L, 390F L, 583T, 587T, 621B, 621G, 623G, 627F, 627G, 631D, 631E, 631G, 633E II, 637D, 637E, 637G, 651B
2323226	CONNECTING ROD BEARING	3412D, C27, C32	773F, 773G, 773G LRC, 773G OEM, 775F, 775G, 775G LRC, 775G OEM, 777C, 777D, 777F, 777G, 844H, 844K, 854K, 990H, 990K, 992K, 993K, AD55B, AD60, D10N, D10R, D10T, D10T2, D11R, D11T
2613450	CONNECTING ROD BEARING	C15, C18	374F L, 390F L, 735B, 740B, 770G, 772G, 824K, 825K, 826K, 834K, 836K, 988K, C18 I6, CX31-C18I, CX35-C18I, D8T, D9T, TH35-C15T
2920484	CONNECTING ROD BEARING	C11	14M, 16H, 16M, 345C, 345C L, 345C MH, 345D, 345D L, 345D L VG, 349D, 349D L, 349E, 349E L, 349E L HVG, 349E L VG, 349F L, 365B, 365B II, 365B L, 621H, 621K, 623H, 623K, 623K LRC, 627H, 627K, 627K LRC

\*\* (ARRIVING EARLY 2022)

\* Other part no. not included in the list are available. Please contact your sales representative if you have any questions. Part Numbers are used for reference purposes only.

## CONNECTING ROD BEARINGS - Con't.

Part No.	Description	Engine	Application
2M6499	CONNECTING ROD BEARING	D342, D342C, G342C	D8H
3285572	CONNECTING ROD BEARING	1673C, 3304, 3304B, 3306, 3306B, 3306C	120G, 12G, 12H, 12H ES, 12H NA, 140G, 140H, 140H ES, 140H NA, 143H, 14G, 14H NA, 160H, 160H ES, 160H NA, 163H NA, 235B, 330, 330B L, 350, 515, 517, 518C, 525
3285573	CONNECTING ROD BEARING	3406B, 3406C, 3406E, 3456	16G, 16H NA, 375, 375 L, 385B, 5080, 5090B, 578, 583R, 587R, 621F, 621G, 623E, 623F, 623G, 627B, 627F, 627G, 651B, 657B, 735, 740, 814B, 824C, 824G, 824G II, 825G, 825G II
3285574	CONNECTING ROD BEARING	3406B, 3406C, 3408, 3408C, 3408E, 3412, 3412C, 3412E	24H, 5110B, 589, 631D, 631E, 631G, 633E II, 637E, 637G, 651E, 657E, 769C, 769D, 771C, 771D, 773B, 773D, 773E, 775B, 775D, 775E, 834B, 836, 844
4P8167	CONNECTING ROD BEARING	3406, 3406B, 3406C, 3408, 3408B, 3408C, 3408E, 3412, 3412C, 3412E	16G, 16H NA, 24H, 375, 375 L, 5080, 5110B, 578, 583R, 587R, 589, 621E, 621F, 623E, 623F, 627B, 627E, 627F, 631D, 631E, 631G, 633E II
5144549	CONNECTING ROD BEARING	C13	730, 730C, 735, 349, 349E, 349F, 352, 352F, 14, 14M3, 16, 16M3, 18, 18M3
5257106	KIT-BEARING ROD	STD	C2.2
517637	CONNECTING ROD BEARING	3064, 3066	311, 311B, 311C, 312B, 312C, 312C L, 314C, 318C, 319C, 320 L, 320B, 320C, 320C FM, 320C L, 320D, 320D LRR, 321C, 323D L, 323D LN
517794	CONNECTING ROD BEARING	3064, 3066	311, 311B, 311C, 312B, 312C, 312C L, 314C, 318C, 319C, 320 L, 320B, 320C, 320C FM, 320C L, 320D, 320D LRR, 321C, 323D L, 323D LN
6207-31-3300	CONNECTING ROD BEARING KOMATSU®	STD	S4D95L, S6D95L, SA6D95L
6207-31-3600	CONNECTING ROD BEARING KOMATSU®	SA6D95L-1	
6210-32-3040	CONNECTING ROD BEARING KOMATSU®	STD	EGS500, EGS570, EGS630, HM350, HM400
6732-31-3411	CONNECTING ROD BEARING KOMATSU®	STD	S6D102E, SA6D102E, SAA4D102E, SAA6D102E
7E7894	CONNECTING ROD BEARING	3208	227, 613C, CS-551, PR-1000, PS-500
7M7186	CONNECTING ROD BEARING	D320A	955H
7N2581	CONNECTING ROD BEARING	STD	D346, D348, D349
7W2136	CONNECTING ROD BEARING	D343, G343	825B, 16, 168B, 169, 169B, 983, 824B, 834, 631C, 633C, 637, 657, 666B
7W4816	CONNECTING ROD BEARING	3014, 3056, 3056E	214, 224, 550B, 560B, 564, 574B, 924G, 924GZ, 930G, AP-655C, BB-760, CP-573E, CP-663E, CS-563E, CS-583E, CS-663E, CS-683E, IT28G, M316C, M318C, M318C MH, M322C
7W5844	CONNECTING ROD BEARING	3176, 3176B, 3176C	140H, 143H, 14H, 160H, 163H, 345B, 345B II, 345B II MH, 345B L, 480, 572R II, 65E, 725, 75, 75C, 75D, 75E, 814F, 815F, 816F, 85C, 966G II, C-10, CPT372, D7R II, R1600, R1600G
8N1849	CONNECTING ROD BEARING	3304, 3304B, 3306, 3306B	120G, 12G, 12H, 12H ES, 12H NA, 130G, 140G, 140H, 140H ES, 140H NA, 143H, 14G, 14H NA, 160G, 160H, 160H ES, 160H NA, 163H NA, 1673C, 225, 235, 235B, 330, 330 FM L, 330 L,
8N1985	CONNECTING ROD BEARING	G3304, G3304B, G3306, G3306B	130G, 3304, 3306, 920, 930, 941, 955L, D5B
8N5338	CONNECTING ROD BEARING	D343, G343	1693, 657B, 666B
8N6308	CONNECTING ROD BEARING	3204	215, 931B, 943, 953, D3, D4HTSK II, D5C
8N7769	CONNECTING ROD BEARING	D379B, D398, G399	GENERATOR, INDUSTRIAL, MARINE
8N7933	CONNECTING ROD BEARING	D339	D6600, D7700, D8800, D8841

\*\* (ARRIVING EARLY 2022)

\* Other part no. not included in the list are available. Please contact your sales representative if you have any questions. Part Numbers are used for reference purposes only.

## CONNECTING ROD BEARINGS - Con't.

Part No.	Description	Engine	Application
9N5923	CONNECTING ROD BEARING	3208	INDUSTRIAL, MARINE
9Y6188	CONNECTING ROD BEARING	3406B, 3408, 3408B, 3408C, 3408E, 3412, 3412C, 3412E	24H, 5110B, 589, 631D, 631E, 631G, 633E II, 637E, 637G, 651E, 657E, 69D, 769C, 769D, 771C, 771D, 773B, 773D, 773E, 775B, 775D, 775E, 834B, 836
9Y7735	CONNECTING ROD BEARING	STD	3406, 3406B, 3406C, 3406E,

## CONNECTING ROD BEARING KITS

Part No.	Description	Engine	Application
4367781	CONNECTING ROD BEARING KIT	C6.6 , C7.1	525D, 535D, 545D, 555D
1566978	CONNECTING ROD BEARING KIT	3013, 3013C, C1.1, C1.5, C2.2	302.5, 303.5, CB-214D, CB-214E, CB-22, CB-334D, CB-334E, CB-335D, CB-34, CB22B, CB24B, CB32B, CC24B
1731272	CONNECTING ROD BEARING KIT	3034	216, 236, 247, 248, 267, 287, 906
2257781	CONNECTING ROD BEARING KIT	3054C, 3054E, C4.4	315C, 414E, 416D, 416E, 420D, 420E, 422E, 424D, 428D, 428E, 430D, 432D, 432E, 434E, 442D, 914G, AP-650B, AP-800D, CB-534D, CB-564D, CD-54, CP-433E, CS-433E, CS-533E, IT14G, M313C
2388282	CONNECTING ROD BEARING KIT	3044C	236B, 236B3, 242B3, 246C, 252B, 252B3, 256C, 257B3, 259B3, 262C, 262C2, 267B, 268B, 272C, 277C, 277C2, 279C, 279C2, 287C, 287C2, 289C, 289C2, 297C, 299C, 303C CR, 304C CR, 305.5D, 305C CR, 305D
3532748	CONNECTING ROD BEARING KIT	C3.3	
3532752	CONNECTING ROD BEARING KIT	3056, 3056E	924G, 924GZ, 930G, AP-655C, BB-760, CP-573E, CP-663E, CS-563E, CS-583E, CS-663E, CS-683E, IT28G, M316C, M318C, M318C MH, M322C
3601564	CONNECTING ROD BEARING KIT	C6.6	120M, 120M 2, 12M, 2384C, 2470C, 2484C, 2570C, 2670C, 320D GC, 320D L, 320D2, 320D2 GC, 320D2 L, 320E, 320E L, 320E LN, 320E LRR, 320E RR, 323D L, 323D2 L, 323E L, 324E, 324E L, 324E LN, 329E, 329E L
3603986	CONNECTING ROD BEARING KIT	3054C	312D2, 312D2 GC, 312D2 L, 312E, 312E L, 313D2, 313D2 LGP, 314E CR, 314E LCR, 316E L, 318D2 L, 318E L, 414E, 416E, 416F, 420E, 420F, 422E, 422F, 428D, 428E, 428F, 430D, 430E, 430F, 432E, 432F
4P9944	CONNECTING ROD BEARING KIT	3054B	416B, 416C, 416D, 420D, 424D, 426C, 428C, 428D, 430D, 432D, 436C, 438C, 438D, 442D, BG-225B, CB-534B, CP-433C, CS-431C, PS-300B, TH83

## CONNECTING ROD BUSHINGS

Part No.	Description	Engine	Application
1181655	CONNECTING ROD BUSHING	3508, 3508B, 3508C, 3512, 3512B, 3512C, 3516, 3516B, 3516C	5130, 5130B, 5230, 5230B, 776C, 776D, 777, 777B, 777C, 777D, 784B, 784C, 785, 785B, 785C, 789, 789B, 789C, 789D, 793B, 793C, 793D, 797, 797B
1243531	CONNECTING ROD BUSHING	3054, 3056	914G, IT14G, M312, M315
1282958	CONNECTING ROD BUSHING	3044C, 3046	236B, 236B3, 242B3, 246C, 252B, 252B3, 256C, 257B3, 259B3, 262C, 262C2, 267B, 268B, 272C, 277C, 277C2, 279C, 279C2, 287C, 287C2, 289C, 289C2, 297C, 299C, 315B, 315C, 317B LN, 318B, 906, 906H
1382048	CONNECTING ROD BUSHING	3054, 3054B, 3056, 3056E	312B L, 312C, 315B L, 416C, 416D, 420D, 424D, 426C, 428D, 430D, 432D, 436C, 438D, 442D, 550B, 554, 560B, 564, 574B, 924G, 924GZ, 930G, AP-655C, AP-800C, BB-760, BG-225B
1540869	CONNECTING ROD BUSHING	3013, 3013C, 3014, 3024, 3024C, C2.2	216, 216B, 216B3, 226B, 226B3, 232B, 242B, 247B, 247B3, 257B, 302.5, 303.5, 304.5, 902, AP-255E, BB-621C, C1.1, C1.5, C2.2, CB-214D, CB-214E, CB-22, CB-334D, CB-334E
1608194	CONNECTING ROD BUSHING	C9	12H, 140M, 140M 2, 160M, 160M 2, 2290, 2390, 2391, 2491, 2590, 330C, 330C FM, 330C L, 330C MH, 330D, 330D FM, 330D L, 330D LN, 330D MH, 336D, 336D L, 336D LN, 336D2, 336D2 L, 340D L, 340D2 L, 511, 521
1888543	CONNECTING ROD BUSHING	3034	216, 228, 236, 247, 248, 267, 287, 906

\*\* (ARRIVING EARLY 2022)

\* Other part no. not included in the list are available. Please contact your sales representative if you have any questions. Part Numbers are used for reference purposes only.



## CONNECTING ROD BUSHINGS - Con't.

Part No.	Description	Engine	Application
1M6107	CONNECTING ROD BUSHING	1693, D343, G343	631C, 641, 651, 657, 657B, 666, 769, 824B, 825B, 834
1W9166	CONNECTING ROD BUSHING	3508, 3512, 3516, G3512, G3516	785
2255438	CONNECTING ROD BUSHING	3054, 3054B, 3054C, 3054E, 3056, 3056E	312D2, 312D2 GC, 312D2 L, 313D2, 313D2 LGP, 315C, 318D2 L, 414E, 416D, 416E, 416F, 420D, 420E, 420F, 422E, 422F, 424D, 426C, 428D, 428E, 428F, 430D, 430E, 430F
2255965	CONNECTING ROD BUSHING	C27, C32	773F, 775F, 777D, 777F, 844H, 854K, 990H, 992K, 993K, AD55B, D10N, D10R, D10T, D11R, D11T, TH48-E70
2767478	CONNECTING ROD BUSHING	C6.6	120M, 120M 2, 12M, 2384C, 2470C, 2484C, 2570C, 2670C, 312E, 312E L, 314E CR, 314E LCR, 316E L, 318E L, 320D GC, 320D L, 320D2, 320D2 GC, 320D2 L, 320E, 320E L, 320E LN, 320E LRR, 320E RR, 323D L, 323D
2941748	CONNECTING ROD BUSHING	C6.4	311D LRR, 312D, 312D L, 313D, 314D CR, 314D LCR, 315D L, 318D L, 319D, 319D L, 319D LN, 320D, 320D FM, 320D FM RR, 320D GC, 320D L, 320D LN, 320D LRR, 320D RR, 321D LCR, 323D L, 323D LN, 323D SA
2964663	CONNECTING ROD BUSHING	C6.4, S6KT	311D LRR, 312D, 312D L, 313D, 314D CR, 314D LCR, 315D L, 318D L, 319D, 319D L, 319D LN
2W0027	CONNECTING ROD BUSHING	3114, 3116, 3126, 3126B, 3126E	120H, 120H ES, 120H NA, 120K, 120K 2, 12K, 12M, 135H, 135H NA, 140G, 140K, 140K 2, 140M, 160K, 211B, 214B, 30/30, 320 L, 320B, 322 LN, 322B L, 322B LN, 322C, 322C FM
3202352	CONNECTING ROD BUSHING	G3406, G3408, G3408B, G3408C, G3412, G3412C	583R, CG137-08, CG137-12, D8R, D8R II,
3775237	CONNECTING ROD BUSHING	3512B, 3512C, 3516B, 3516C	785D, 789C, 789D, 793C, 793D, 797, 797B, 994F, 994H, G3516H, PM3516, SPF343C, TH48-E80, XQC1200, XQC1600
4M9183	CONNECTING ROD BUSHING	D342, D342C, D8H, G342C	D8K
4P8495	CONNECTING ROD BUSHING	3406, 3406B, 3406C, 3408, 3408B, 3408C, 3408E, 3412, 3412C, 3412E	16G, 16H NA, 24H, 375, 375 L, 5080, 5110B, 578, 583R, 587R, 589, 621E, 621F, 623E, 623F, 627B, 627E, 627F, 631D, 631E, 631G, 633E II
5I7539	CONNECTING ROD BUSHING	3064, 3066	311, 311B, 311C, 312B, 312C, 312C L, 314C, 318C, 319C, 320 L, 320B, 320C, 320C FM, 320C L, 320D, 320D LRR, 321C, 323D L, 323D LN
6732-31-3132	CONNECTING ROD BUSHING KOMATSU®	STD	S4D102E, S6D102E, S6D102E1, SA6D102E, SAA4D102E, SAA4D107E, SAA6D102E, SAA6D107E
676158	CONNECTING ROD BUSHING	6.354	213
6I2726	CONNECTING ROD BUSHING	3406B, 3406C, 3406E, 3456	375 L, 385B, 5090B, 578, 583R, 621G, 623G, 627G, 651B, 735, 824C, 824G, 825G, 826C, 826G, 834G, 836G, 980C, 980G, 988G, C-15, C-16, C16, D8N, D8R, D8R II, PM3456
7W2510	CONNECTING ROD BUSHING	3054, 3056	212, 224, 312, 315, 317, 416B, 416C, 426B, 426C, 428, 428B, 428C, 436C, 438C, AP-800C, BG-225B, CB-534B, CB-534C, CB-535B, CP-433C, CS-431C, PS-200B, PS-300B, RT50, TH103, TH62, TH63, TH82
8N0701	CONNECTING ROD BUSHING	3208	225, 613B, CS-551, FB221, PR-1000, PS-500
8N0702	CONNECTING ROD BUSHING	G3304, G3306	920, 955L, D6R II
8N0703	CONNECTING ROD BUSHING	1673C, 3306	571G, 621R, 637D, D7F, D7G
8N0705	CONNECTING ROD BUSHING	3406, 3408, 3412	621B, 623B, 631D, 633D, 637D, 639D, 733B, 825C, 826C, 834B, 980C, 983C, 988B, 992C, D8L
8N0706	CONNECTING ROD BUSHING	3406, 3406B, 3406C	637D, 988B
8N2275	CONNECTING ROD BUSHING	D379B, D398, D9H, G398, G399	INDUSTRIAL
9F1848	CONNECTING ROD BUSHING	D315	955C, 977D
9N5082	CONNECTING ROD BUSHING	3204, 3208	215, 225, 227, 613B, 613C, 931B, 943, 953, D3, D4HTSK II, D5C, PR-1000, PS-500

# CAMSHAFT BUSHINGS

Part No.	Description	Engine	Application
1011198	CAMSHAFT BUSHING	3508, 3508B, 3508C, 3512, 3512B, 3512C, 3516, 3516B, 3516C, 5130B, 5230B	776D, 777, 777B, 777C, 777D, 784C, 785, 785B, 785C, 785D, 789, 789B, 789C, 789D, 793C, 793D, 797, 797B, 854G, 992G, 994D, 994F.
1161359	CAMSHAFT BUSHING	3508, 3508B, 3508C, 3512, 3516, 3516B	5130, 5230, 5230B, 776C, 784B, 785, 785B, 789B, 793B, 994, D11N, D11R, G3508, G3508B, G3512, G3512B, G3512E, G3516, G3516B, G3516C, G3516E, G3516H, PM3512, PM351
1878969	CAMSHAFT BUSHING	C13	14M, 16M, 345C, 345C L, 345C MH, 345D, 345D L, 345D L VG, 349D, 349D L, 349E, 349E L, 349E L HVG, 349E L VG, 349F L, 621H, 621K, 623H, 623K, 623K LRC, 627H, 627K, 627K LRC, 725, 730, 730C, 966H, 972H
1W5920	CAMSHAFT BUSHING	3204	215, 931B, 943, 953, D3, D4HTSK II, D5C
2035805	CAMSHAFT BUSHING (CENTER)	C9	D6R
2036090	CAMSHAFT BUSHING (REAR)	C9	12H, 12M 2, 12M 3, 12M 3 AWD, 140M, 140M 2, 140M 3, 140M 3 AWD, 160M, 160M 2, 160M 3, 160M 3 AWD, 2290, 2390, 2391, 2491, 2590, 2864C, 330C, 330C FM, 330C L, 330C MH, 330D, 330D FM, 330D L, 330D LN
2165582	CAMSHAFT BUSHING	3406E, 3456	24M, 365C, 365C L, 365C L MH, 374D L, 374F L, 385B, 385C, 385C FS, 385C L, 385C L MH, 390D, 390D L, 390F L, 5090B, 583T, 587T, 621B, 621G, 623G, 627F, 627G, 631D, 631E, 631G, 633E II
2165583	CAMSHAFT BUSHING (CENTER)	3176C, 3196, C-10, C-12, C12	140H, 143H, 14H, 160H, 163H, 16H, 345B, 345B II, 345B II MH, 345B L, 365B, 365B II, 365B L, 480, 572R II, 65E, 725, 730, 75E, 814F, 815F, 816F, 85E, 95E, 966G II, 972G II,
2165584	CAMSHAFT BUSHING (FRONT)	3176C, 3196, C-10, C-12, C12	140H, 143H, 14H, 160H, 163H, 16H, 345B, 345B II, 345B II MH, 345B L, 365B, 365B II, 365B L, 480, 572R II, 65E, 725, 730, 75E, 814F, 815F, 816F, 85E, 95E, 966G II, 972G II,
2165585	CAMSHAFT BUSHING (REAR)	3176C, 3196, C-10, C-12, C12	140H, 143H, 14H, 160H, 163H, 16H, 345B, 345B II, 345B II MH, 345B L, 365B, 365B II, 365B L, 480, 572R II, 65E, 725, 730, 75E, 814F, 815F, 816F, 85E, 95E, 966G II, 972G II,
2165586	CAMSHAFT BUSHING (FRONT)	C9	120H, 120H ES, 120H NA, 120K, 120K 2, 12H, 12K, 12M, 12M 2, 12M 3, 12M 3 AWD, 135H, 135H NA, 140G, 140K, 140K 2, 140M, 140M 2, 140M 3, 140M 3 AWD, 160K, 160M, 160M 2, 160M 3, 160M 3 AWD, 2290, 2390
2H2330	CAMSHAFT BUSHING	D353C	594, D9E, D9G, D9H
2H7878	CAMSHAFT BUSHING	D353C	594, D9E, D9G, D9H
2W7213	CAMSHAFT BUSHING	3114, 3116, 3126, 3126B, 3126E	120H, 120H ES, 120H NA, 120K, 120K 2, 12K, 12M, 135H, 135H NA, 140G, 140K, 140K 2, 140M, 160K, 211B, 214B, 30/30, 320 L, 320B, 322 LN, 322B L, 322B LN, 322C, 322C FM
4H9640	CAMSHAFT BUSHING	D342, D342C	583H, 583K, 630B, D8H, D8K, G342C
4N0685	CAMSHAFT BUSHING	3406, 3406B, 3406C, 3408, 3408B, 3408C, 3408E, 3412, 3412C, 3412D, 3412E	16G, 16H NA, 245, 245B, 245D, 24H, 375, 375 L, 5080, 5110B, 578, 583R, 587R, 589, 621, 621B, 621E, 621F, 623E, 623F, 627B
4N6658	CAMSHAFT BUSHING	3406, 3406B, 3406C, 3408, 3408B, 3408C, 3408E, 3412, 3412C, 3412D, 3412E	16G, 16H NA, 245, 245B, 245D, 24H, 375, 375 L, 5080, 5110B, 578, 583R, 587R, 589, 621, 621B, 621E, 621F, 623E, 623F, 627B
5I7528	CAMSHAFT BUSHING	C13	311, 311B, 311C, 311D LRR, 312, 312B, 312C, 312C L, 312D, 312D L, 313D, 314C, 314D CR, 314D LCR, 315, 315B, 315C, 315D L, 317B LN, 318B, 318C, 318D L, 319C, 319D, 319D L, 319D LN, 320, 320 L, 320B
5I7529	CAMSHAFT BUSHING	C13	311, 311B, 311C, 311D LRR, 312, 312B, 312C, 312C L, 312D, 312D L, 313D, 314C, 314D CR, 314D LCR, 315, 315B, 315C, 315D L, 317B LN, 318B, 318C, 318D L, 319C, 319D, 319D L, 319D LN, 320, 320 L, 320B

\*\* (ARRIVING EARLY 2022)

\* Other part no. not included in the list are available. Please contact your sales representative if you have any questions. Part Numbers are used for reference purposes only.

## CAMSHAFT BUSHINGS - Con't.

Part No.	Description	Engine	Application
5L2894	CAMSHAFT BUSHING	D379A, D379B, D398A, D398B, D399, G379, G398, G399	INDUSTRIAL
5M3560	CAMSHAFT BUSHING	D343	631C, 633C, 651, 657, 657B, 666, 769, 824
5M3603	CAMSHAFT BUSHING	D343	631C, 633C, 651, 657, 657B, 666, 769, 824
7F8294	CAMSHAFT BUSHING	D315	955C, 977D
7F8295	CAMSHAFT BUSHING	D315	955C, 977D
7M4046	CAMSHAFT BUSHING	3304, 3306	120B, 120G, 12E, 12G, 12H, 12H ES, 12H NA, 130G, 140B, 140G, 140H, 140H ES, 140H NA, 143H, 14G, 14H NA, 160G, 160H, 160H ES, 160H NA, 163H NA, 1673B, 1673C, 215B, 225, 235, 235B, 330, 330 L
7N2048	CAMSHAFT BUSHING	3508, 3512, 3516, 5130, 5230, G3508, G3512, G3516	776C, 777B, 784B, 785, 785B, 789, 789B, 793B, 994, D11N
8F8523	CAMSHAFT BUSHING	D342, D342C, G342C	583H, 583K, D8H, D8K
8N4110	CAMSHAFT BUSHING	3304, 3304B, 3306, 3306B, 3306C	120G, 12G, 12H, 12H ES, 12H NA, 130G, 140B, 140G, 140H, 140H ES, 140H NA, 143H, 14G, 14H NA, 160G, 160H, 160H ES, 160H NA, 163H NA, 1673C, 215B, 235, 235B, 330, 330 L
9M5477	CAMSHAFT BUSHING	1673B, 1673C, D330A, D330B, D333A,	120B, 120G, 12E, 130G, 140B, 225, 235, 3304, 3306, 561B, 637D, 930, 941, 950, 955H, 955L, 966C, D4D, D5, D6C, D6D, D7F
9N5246	CAMSHAFT BUSHING	3204, 3208	215, 613C, 926, 931B, 943, CS-551, D4HTSK II, E180, FB221, PR-1000, PS-500

## BALANCE SHAFT BUSHINGS

Part No.	Description	Engine	Application
5I7542	BUSHING (IDLER GEAR)	3064, 3066	311B, 311C, 312C, 312C L, 314C, 318C, 319C, 320 L, 320B, 320C, 320C FM, 320C L, 320D, 320D LRR, 321B, 321C, 323D L, 323D LN
8F8521	BALANCE SHAFT BUSHING	D339	D7, D8
8F8522	BALANCE SHAFT BUSHING	D339	D7, D8
9M5236	BALANCE SHAFT BUSHING (END)	D320A	INDUSTRIAL
9M5237	BALANCE SHAFT BUSHING (CENTER)	D320A	INDUSTRIAL
9M5238	BALANCE SHAFT BUSHING	D330A, D330B	955H, D4D
9M5239	BALANCE SHAFT BUSHING	D330A, D330B	955H, D4D
9Y2991	BALANCE SHAFT BUSHING	3304, 3304B, G3304, G3304B	120G, 130G, 215B, 515, 517, 518C, 525, 527, CB-534, D4E SR, D4H, D4H XL, D4HTSK III, D5HTSK II,
9Y2992	BALANCE SHAFT BUSHING	3304, 3304B, G3304, G3304B	120G, 130G, 215B, 515, 517, 518C, 525, 527, CB-534, D4E SR, D4H, D4H XL, D4HTSK III, D5HTSK II,

## CRANKSHAFT BUSHINGS

Part No.	Description	Engine	Application
2944916	CRANKSHAFT BUSHING	3013, 3013C, 3014, 3024, 3024C,	216, 216B, 216B3, 226B, 226B3, 232B, 242B, 247B, 247B3, 257B, 303.5, 304.5, AP-255E, BB-621C, C1.1, C1.5, C2.2, CB-214D, CB-214E, CB-22, CB-334D, CB-334E, CB-335

\*\* (ARRIVING EARLY 2022)

\* Other part no. not included in the list are available. Please contact your sales representative if you have any questions. Part Numbers are used for reference purposes only.

## IDLER GEAR BUSHINGS

Part No.	Description	Engine	Application
1409597	BUSHING (IDLER GEAR)	3508, 3508B, 3508C, 3512, 3512B, 3512C, 3516, 3516B, 3516C, 5130B, 5230, 5230B	776C, 776D, 777, 777B, 777C, 777D, 784C, 785, 785B, 785C, 785D, 789, 789B, 789C, 789D, 793B, 793C, 793D, 797, 797B, 854G
0676899	BUSHING (IDLER GEAR)	3054, 3054B, 3056	206, 307, 312, 312B L, 312C, 315, 315B L, 317, 416B, 416C, 416D, 420D, 424D, 426B, 426C, 428B, 428C, 428D, 430D, 432D, 436C, 438C, 438D, 442D, 554, 564, 908, 914G, 924G, 924GZ

## CAMSHAFT THRUST PLATE

Part No.	Description	Engine	Application
4S6417	PLATE-THRUST BALANCER	3304, 3304B, D320A, D330A, G3304, G3304B	120G, 130G, 215B, 225, 515, 517, 518C, 525, 527, 920, 936F, 941, 950, 951B, 955H, D4D, D4E, D4E SR, D4H, D4H XL, D4HTSK III, D5H, D5H XL, D5HTSK II

## BALANCE SHAFT THRUST PLATES

Part No.	Description	Engine	Application
1077694	PLATE-THRUST CAMSHAFT	C9	120H, 120H ES, 120H NA, 120K, 120K 2, 12H, 12K, 12M, 12M 2, 12M 3, 12M 3 AWD, 135H, 135H NA, 140G, 140K, 140K 2, 140M, 140M 2, 140M 3, 140M 3 AWD, 160K, 160M, 160M 2, 160M 3, 160M 3 AWD, 2290, 2390
5I7650	PLATE-THRUST CAMSHAFT	3066	311, 311B, 311C, 311D LRR, 312B, 312C, 312C L, 312D, 312D L, 313D, 314C, 314D CR, 314D LCR, 315D L, 318C, 318D L, 319C, 319D, 319D L, 319D LN, 320 L, 320B, 320C, 320C FM, 320C L, 320D, 320D FM, 320D F
7W4842	PLATE-THRUST CAMSHAFT	3054, 3054B, 3056	224, 307, 312, 312C, 315, 317, 416B, 416C, 416D, 424D, 426B, 426C, 428B, 428C, 436C, 438C, 554, 914G, 924G, 924GZ, AP-800C, BG-225B, BG-225C, CB-434B, CB-434C, CB-534B, CB-534C

# UNDERSIZE & OVERSIZE BEARINGS

**Undersize** = when the crankshaft has been re-ground "undersize"

## UNDERSIZE MAIN BEARINGS

Part No.	Description	Undersize	Engine	Application
4484218	KIT-BEARING MAIN	(0.25-MM US)	C6.6, C7.1	DE150GC, DE200E0, DE200GC
0332379	MAIN BEARING	.25MM / 0.010IN	3054, 3054T	INDUSTRIAL, MACHINE
0332381	MAIN BEARING KIT	.75MM / 0.030IN	3054B	416B, 416C, 416D, 420D, 424D, 426C, 428C, 428D, 430D, 432D, 436C, 438C, 438D, 442D, BG-225B, CB-534B, CP-433C, CS-431C, PS-300B, TH83, WE-601B
1145609	MAIN BEARING SET	.25MM / 0.010IN	3046	315, 315B, 315C, 317B LN, 318B, 933, 933C, 939, 939C, D3C III, D3G, D4C III, D4G, D5C III, D5G
1145610	MAIN BEARING SET	.50MM / 0.020IN	3046	315, 315B, 315C, 317B LN, 318B, 933, 933C, 939, 939C, D3C III, D3G, D4C III, D4G, D5C III, D5G
1145611	MAIN BEARING SET	.75MM / 0.030IN	3046	315, 315B, 315C, 317B LN, 318B, 933, 933C, 939, 939C, D3C III, D3G, D4C III, D4G, D5C III, D5G
1280382	MAIN BEARING	.50MM / 0.020IN	3176C, 3196	140H, 143H, 14H, 14M, 160H, 163H, 16H, 16M, 345B, 345B II, 345B II MH, 345B L, 345C, 345C L, 345C MH, 345D, 345D L, 345D L VG, 349D, 349D L, 349E, 349E L, 349E L HVG, 349E L VG, 349F L

\*\* (ARRIVING EARLY 2022)

\* Other part no. not included in the list are available. Please contact your sales representative if you have any questions. Part Numbers are used for reference purposes only.

## UNDERSIZE MAIN BEARINGS - Con't.

Part No.	Description	Undersize	Engine	Application
1280400	MAIN BEARING	.50MM / 0.020IN	3176C, 3196	140H, 143H, 14H, 14M, 160H, 163H, 16H, 16M, 345B, 345B II, 345B II MH, 345B L, 345C, 345C L, 345C MH, 345D, 345D L, 345D L VG, 349D, 349D L, 349E, 349E L, 349E L HVG, 349E L VG, 349F L
1280401	MAIN BEARING	.75MM / 0.030IN	3176C, 3196	140H, 143H, 14H, 14M, 160H, 163H, 16H, 16M, 345B, 345B II, 345B II MH, 345B L, 345C, 345C L, 345C MH, 345D, 345D L, 345D L VG, 349D, 349D L, 349E, 349E L, 349E L HVG, 349E L VG, 349F L
1450162	MAIN BEARING	.25MM / 0.010IN	3114, 3116, 3126, 3126B, 3126E	120H, 120H ES, 120H NA, 120K, 120K 2, 12K, 12M, 135H, 135H NA, 140G, 140K, 140K 2, 140M, 160K, 214B, 30/30, 320B, 322B L, 322B LN, 322C, 322C FM, 324D, 324D FM, 324D FM
1450163	MAIN BEARING	.25MM / 0.010IN	3114, 3116	213B, 214B, 320A, 320B, 322A, 322B, 325, E200B, E240B, EL200B, EL240B, EL240C, IT28F, IT28G
1450164	MAIN BEARING	.50MM / 0.020IN	3114, 3116, 3126, 3126B, 3126E	120H, 120H ES, 120H NA, 120K, 120K 2, 12K, 12M, 135H, 135H NA, 140G, 140K, 140K 2, 140M, 160K, 214B, 30/30, 320B, 322B L, 322B LN, 322C, 322C FM, 324D, 324D FM, 324D FM
1450165	MAIN BEARING	.50MM / 0.020IN	3114, 3116	120H, 120H ES, 120H NA, 120K, 120K 2, 12K, 12M, 135H, 135H NA, 140G, 140K, 140K 2, 140M, 160K, 214B, 30/30, 320B, 322B L, 322B LN, 322C, 322C FM, 324D, 324D FM, 324D FM
1450171	MAIN BEARING	.50MM / 0.020IN	3116	213B, 214B, 224B, 320A, 320B, 322A, 322B, 325A, 325B, E200B, E240B, E200C, 3116 MARINE
1496032	MAIN BEARING	.63MM / 0.025IN	3508, 3508B, 3508C, 3512, 3512B, 3512C, 3516, 3516B, 3516C	5130, 5130B, 5230, 5230B, 776C, 776D, 777, 777B, 777C, 777D, 784C, 785, 785B, 785C, 785D, 789, 789B, 789C, 789D, 793C, 793D, 797, 797B, 854G
1496033	MAIN BEARING	1.25MM / 0.050IN	3508, 3508B, 3508C, 3512, 3512B, 3512C, 3516, 3516B, 3516C	5130, 5130B, 5230, 5230B, 776C, 776D, 777, 777B, 777C, 777D, 784C, 785, 785B, 785C, 785D, 789, 789B, 789C, 789D, 793C, 793D, 797, 797B, 854G
1617163	MAIN BEARING SET	.25MM / 0.010IN	C2.2	216, 216B, 226B, 232B, 242B, 247B, 257B, 3014, 3024, 3024C, 304.5, CB-334E
1617164	MAIN BEARING SET	.50MM / 0.020IN	C2.2	216, 216B, 226B, 232B, 242B, 247B, 257B, 3014, 3024, 3024C, 304.5, CB-334E
1H3728	MAIN BEARING (CENTER)	.75MM / 0.030IN	D315	MARINE
1H3729	MAIN BEARING (FRONT)	.75MM / 0.030IN	D315	MARINE
1H3730	MAIN BEARING (INTERMEDIATE)	.75MM / 0.030IN	D315	MARINE
1H3731	MAIN BEARING (REAR)	.75MM / 0.030IN	D315	MARINE
1N4319	MAIN BEARING	.25MM / 0.010IN	D353	D9
1N4319-030	MAIN BEARING	.75MM / 0.030IN	D353	D9
1N4320	MAIN BEARING	.25MM / 0.010IN	D353	D9
1N4321	MAIN BEARING	.25MM / 0.010IN	D353	D9
1N4322	MAIN BEARING	1.25MM / 0.050IN	D353	D9
1N4323	MAIN BEARING	1.25MM / 0.050IN	D353	D9

\*\* (ARRIVING EARLY 2022)

\* Other part no. not included in the list are available. Please contact your sales representative if you have any questions. Part Numbers are used for reference purposes only.

## UNDERSIZE MAIN BEARINGS - Con't.

Part No.	Description	Undersize	Engine	Application
1N4324	MAIN BEARING	1.25MM / 0.050IN	D353	D9
1N4332	MAIN BEARING	.25MM / 0.010IN	D353	D9
1N4333	MAIN BEARING	1.25MM / 0.050IN	D353	D9
1S7578	MAIN BEARING (REAR)	1.25MM / 0.050IN	D342	D7, D8
1W1655	MAIN BEARING	.25MM / 0.010IN	3204	953
1W1656	MAIN BEARING	.50MM / 0.020IN	3204	953
1W1656-030	MAIN BEARING	.75MM / 0.030IN	3204	953
1W1656-040	MAIN BEARING	1.00MM / 0.040IN	3204	953
1W1657	MAIN BEARING	1.25MM / 0.050IN	3204	953
1W1661	MAIN BEARING-NON-GROOVED	.25MM / 0.010IN	3204	953
1W1662	MAIN BEARING-NON-GROOVED	.50MM / 0.020IN	3204	953
1W1662-030	MAIN BEARING-NON-GROOVED	.75MM / 0.030IN	3204	953
1W1662-040	MAIN BEARING-NON-GROOVED	1.00MM / 0.040IN	3204	953
1W1663	MAIN BEARING-NON-GROOVED	1.25MM / 0.050IN	3204	953
2333785	MAIN BEARING SET	.50MM / 0.020IN	3054C, 3054E	315C, 414E, 416D, 416E, 420D, 420E, 422E, 424D, 428D, 428E, 430D, 430E, 432D, 432E, 434E, 442D, 442E, 444E, 450E, 914G, AP-300, AP-300D, AP-650B, AP-800D, AP555E, BG500E, C4.4, CB-434D
2333786	MAIN BEARING SET	.75MM / 0.030IN	3054C, 3054E	312D2, 312D2 GC, 312D2 L, 313D2, 313D2 LGR, 315C, 318D2 L, 414E, 416D, 416E, 416F, 420D, 420E, 420F, 422E, 422F, 424D, 428D, 428E, 428F, 430D, 430E, 430F, 432D, 432E, 432F, 434E, 434F
2821771	MAIN BEARING	.25MM / 0.010IN	C9	12H, 12M 2, 12M 3, 12M 3 AWD, 140M, 140M 2, 140M 3, 140M 3 AWD, 160M, 160M 2, 160M 3, 160M 3 AWD, 2290, 2390, 2391, 2491, 2590, 2864C, 330C, 330C FM, 330C L, 330C MH, 330D, 330D FM, 330D L, 330D LN
2821772	MAIN BEARING	.50MM / 0.020IN	C9	12H, 12M 2, 12M 3, 12M 3 AWD, 140M, 140M 2, 140M 3, 140M 3 AWD, 160M, 160M 2, 160M 3, 160M 3 AWD, 2290, 2390, 2391, 2491, 2590, 2864C, 330C, 330C FM, 330C L, 330C MH, 330D, 330D FM, 330D L, 330D LN
2944890	MAIN BEARING KIT	.25MM / 0.010IN	3044C	236B, 236B3, 242B3, 246C, 252B, 252B3, 256C, 257B3, 259B3, 262C, 262C2, 267B, 268B, 272C, 277C, 277C2, 279C, 279C2, 287C, 287C2, 289C, 289C2, 297C, 299C, 906, 906H, 907H, 908H, C3.4

\*\* (ARRIVING EARLY 2022)

\* Other part no. not included in the list are available. Please contact your sales representative if you have any questions. Part Numbers are used for reference purposes only.

## UNDERSIZE MAIN BEARINGS - Con't.

Part No.	Description	Undersize	Engine	Application
2944891	MAIN BEARING KIT	.50MM / 0.020IN	3044C	236B, 236B3, 242B3, 246C, 252B, 252B3, 256C, 257B3, 259B3, 262C, 262C2, 267B, 268B, 272C, 277C, 277C2, 279C, 279C2, 287C, 287C2, 289C, 289C2, 297C, 299C, 906, 906H, 907H, 908H, C3.4
2H2450	MAIN BEARING (CENTER)	.25MM / 0.010IN	D342	D7, D8H 14A
2H2451	MAIN BEARING (FRONT)	.25MM / 0.010IN	D342	D7, D8H 14A
3537416	MAIN BEARING KIT	.25MM / 0.010IN	3056, 3056E	924G, 924GZ, 930G, AP-655C, BB-760, CP-573E, CP-663E, CS-563E, CS-583E, CS-663E, CS-683E, IT28G, M316C, M318C, M318C MH, M322C
3537417	MAIN BEARING KIT	.50MM / 0.020IN	3056, 3056E	924G, 924GZ, 930G, AP-655C, BB-760, CP-573E, CP-663E, CS-563E, CS-583E, CS-663E, CS-683E, IT28G, M316C, M318C, M318C MH, M322C
3537418	MAIN BEARING KIT	.75MM / 0.030IN	3054C, 3054E	312D2, 312D2 GC, 312D2 L, 313D2, 313D2 LGP, 318D2 L, 414E, 416E, 416F, 420E, 420F, 422E, 422F, 428D, 428E, 428F, 430D, 430E, 430F, 432E, 432F, 434E, 434F, 442D, 442E, 444E, 444F, 450E
3537424	MAIN BEARING KIT	.25MM / 0.010IN	3054C, 3054E	312D2, 312D2 GC, 312D2 L, 313D2, 313D2 LGP, 318D2 L, 414E, 416E, 416F, 420E, 420F, 422E, 422F, 428D, 428E, 428F, 430D, 430E, 430F, 432E, 432F, 434E, 434F, 442D, 442E, 444E, 444F, 450E
3537428	MAIN BEARING KIT	.25MM / 0.010IN	3054, 3054B	206, 212, 307, 312, 312B L, 312C, 315, 315B L, 317, 416B, 416C, 416D, 420D, 426B, 426C, 428, 428B, 428C, 430D, 436C, 438C, 554, 908, 914G, AP-800C, BG-225C, CB-424, CB-434B, CB-434C, CB-5
3537429	MAIN BEARING KIT	.50MM / 0.020IN	3054, 3054B	206, 212, 307, 312, 312B L, 312C, 315, 315B L, 317, 416B, 416C, 416D, 420D, 426B, 426C, 428, 428B, 428C, 430D, 436C, 438C, 554, 908, 914G, AP-800C, BG-225C, CB-424, CB-434B, CB-434C, CB-5
3537430	MAIN BEARING KIT	.75MM / 0.030IN	3054, 3054B	206, 212, 307, 312, 312B L, 312C, 315, 315B L, 317, 416B, 416C, 416D, 420D, 426B, 426C, 428, 428B, 428C, 430D, 436C, 438C, 554, 908, 914G, AP-800C, BG-225C, CB-424, CB-434B, CB-434C, CB-5
4484220	MAIN BEARING KIT	.50MM / 0.020IN	C4.4, C6.6 , C7.1	
4543745	MAIN BEARING KIT	.25MM / 0.010IN	C6.6, C7.1	120M, 120M 2, 12M, 2384C, 2470C, 2484C, 2570C, 2670C, 320D GC, 320D L, 320D2, 320D2 GC, 320D2 L, 320E, 320E L, 320E LN, 320E LRR, 320E RR, 323D L, 323D2 L, 323E L, 324E, 324E L, 324E LN, 329E, 329E L
4543931	MAIN BEARING KIT	.50MM / 0.020IN	C6.6, C7.1	120M, 120M 2, 12M, 2384C, 2470C, 2484C, 2570C, 2670C, 320D GC, 320D L, 320D2, 320D2 GC, 320D2 L, 320E, 320E L, 320E LN, 320E LRR, 320E RR, 323D L, 323D2 L, 323E L, 324E, 324E L, 324E LN, 329E, 329E L

\*\* (ARRIVING EARLY 2022)

\* Other part no. not included in the list are available. Please contact your sales representative if you have any questions. Part Numbers are used for reference purposes only.

## UNDERSIZE MAIN BEARINGS - Con't.

Part No.	Description	Undersize	Engine	Application
4543935	MAIN BEARING KIT	.75MM / 0.030IN	C6.6, C7.1	120M, 120M 2, 12M, 2384C, 2470C, 2484C, 2570C, 2670C, 320D GC, 320D L, 320D2, 320D2 GC, 320D2 L, 320E, 320E L, 320E LN, 320E LRR, 320E RR, 323D L, 323D2 L, 323E L, 324E, 324E L, 324E LN, 329E, 329E L
4H5512	MAIN BEARING (CENTER)	1.25MM / 0.050IN	D342	583, D8
4W5492-010	MAIN BEARING	.25MM / 0.010IN	3406, 3406B, 3406E, 3408, 3412, 3412C	16G, 245, 245B, 24H, 375, 375 L, 5080, 5110B, 578, 589, 621E, 623E, 627E, 631G, 637D, 637G, 651E, 657E, 769C, 769D, 771C, 771D, 773B, 773E, 775B, 814B, 824C, 826
4W5492-020	MAIN BEARING	.50MM / 0.020IN	3406, 3406B, 3406E, 3408, 3412, 3412C	16G, 245, 245B, 24H, 375, 375 L, 5080, 5110B, 578, 589, 621E, 623E, 627E, 631G, 637D, 637G, 651E, 657E, 769C, 769D, 771C, 771D, 773B, 773E, 775B, 814B, 824C, 826
4W5690	MAIN BEARING	1.25MM / 0.050IN	D348	641B, 651, 657B, 922
4W5698	MAIN BEARING	.63MM / 0.025IN	3406, 3406B, 3406C, 3406E, 3408, 3408B, 3408C, 3408E, 3412, 3412C, 3412D, 3412E, 3456	16G, 16H NA, 245, 245B, 24H, 24M, 365C, 365C L, 365C L MH, 374D L, 374F L, 375, 375 L, 385B, 385C, 385C FS, 385C
4W5698-040	MAIN BEARING	1.00MM / 0.040IN	3406, 3406B, 3406C, 3406E, 3408, 3408B, 3408C, 3408E, 3412, 3412C, 3412D, 3412E, 3456	16G, 16H NA, 245, 245B, 24H, 24M, 365C, 365C L, 365C L MH, 374D L, 374F L, 375, 375 L, 385B, 385C, 385C FS, 385C
4W5699	MAIN BEARING	1.25MM / 0.050IN	3406, 3406B, 3406C, 3406E, 3408, 3408B, 3408C, 3408E, 3412, 3412C, 3412D, 3412E, 3456	16G, 16H NA, 245, 245B, 24H, 24M, 365C, 365C L, 365C L MH, 374D L, 374F L, 375, 375 L, 385B, 385C, 385C FS, 385C
5I7784	MAIN BEARING KIT	.25MM / 0.010IN	3064, 3066	311, 311B, 311C, 311D LRR, 312, 312B, 312C, 312C L, 312D, 312D L, 313D, 314C, 314D CR, 314D LCR, 315D L, 318C, 318D L, 319C, 319D, 319D L, 319D LN, 320, 320 L, 320B, 320C, 320C FM, 320C L, 320D, 320D
5I7785	MAIN BEARING KIT	.50MM / 0.020IN	3064, 3066	311, 311B, 311C, 311D LRR, 312, 312B, 312C, 312C L, 312D, 312D L, 313D, 314C, 314D CR, 314D LCR, 315D L, 318C, 318D L, 319C, 319D, 319D L, 319D LN, 320, 320 L, 320B, 320C, 320C FM, 320C L, 320D, 320D
5I7786	MAIN BEARING KIT	.75MM / 0.030IN	3064, 3066	311, 311B, 311C, 311D LRR, 312, 312B, 312C, 312C L, 312D, 312D L, 313D, 314C, 314D CR, 314D LCR, 315D L, 318C, 318D L, 319C, 319D, 319D L, 319D LN, 320, 320 L, 320B, 320C, 320C FM, 320C L, 320D, 320D
6136-28-8010 **	MAIN BEARING KOMATSU®	0.50mm	4D105, 6D105, S4D105, S6D105, SA6D111	
6136-29-8010 **	MAIN BEARING KOMATSU®	0.25mm	4D105, 6D105, S4D105, S6D105, SA6D112	
6150-27-8010	MAIN BEARING KOMATSU®	.75MM / 0.030IN	6D125, 6D125E, SAA6D125E	INDUSTRIAL
6150-28-8010	MAIN BEARING KOMATSU®	.50MM / 0.020IN	6D125, 6D125E, SAA6D125E	INDUSTRIAL
6150-29-8010	MAIN BEARING KOMATSU®	.25MM / 0.010IN	6D125, 6D125E, SAA6D125E	INDUSTRIAL
6204-26-8100	MAIN BEARING KOMATSU®	1.00MM / 0.040IN	3D95S, 4D95L, 4D95LE, 4D95S, SAA4D95LE	

\*\* (ARRIVING EARLY 2022)

\* Other part no. not included in the list are available. Please contact your sales representative if you have any questions. Part Numbers are used for reference purposes only.



## UNDERSIZE MAIN BEARINGS - Con't.

Part No.	Description	Undersize	Engine	Application
6204-27-8100	MAIN BEARING KOMATSU®	.75MM / 0.030IN	3D95S, 4D95L, 4D95LE, 4D95S, SAA4D95LE	
6204-28-8100	MAIN BEARING KOMATSU®	.50MM / 0.020IN	3D95S, 4D95L, 4D95LE, 4D95S, SAA4D95LE	
6204-29-8100	MAIN BEARING KOMATSU®	.25MM / 0.010IN	3D95S, 4D95L, 4D95LE, 4D95S, SAA4D95LE	
6204-29-8500	THRUST BEARING KOMATSU®	.25MM / 0.010IN	3D95S, 4D95L, 4D95S, 6D95L, SAA4D95LE	INDUSTRIAL
6210-26-8010 **	MAIN BEARING KOMATSU®	1.00mm	6D140, DCA, EGS500, EGS570, EGS630, HM350, HM400, S6D140, S6D140E, SA6D132, SA6D140, SA6D140A, SA6D140E, SAA6D140E	
6210-27-8010 **	MAIN BEARING KOMATSU®	0.75mm	6D140, DCA, EGS500, EGS570, EGS630, HM350, HM400, S6D140, S6D140E, SA6D132, SA6D140, SA6D140A, SA6D140E, SAA6D140E	
6210-28-8010 **	MAIN BEARING KOMATSU®	0.50mm	6D140, DCA, EGS500, EGS570, EGS630, HM350, HM400, S6D140, S6D140E, SA6D132, SA6D140, SA6D140A, SA6D140E, SAA6D140E	
6210-29-8010 **	MAIN BEARING KOMATSU®	.25MM / 0.010IN	S6D140, S6D140E, SA6D132, SA6D140, SA6D140A, SA6D140E, SAA6D140E	WA500, EGS500, EGS570, EGS630, HM350, HM400
6F1935	MAIN BEARING (FRONT)	1.25MM / 0.050IN	D342C, G342	INDUSTRIAL, MARINE, D8H
6F1936	MAIN BEARING (INTERMEDIATE)	1.25MM / 0.050IN	D342C, G342	D7, D8 14A, D13000
7C6963	MAIN BEARING	.75MM / 0.030IN	3116	120H, 213B, 320 L, 320B, 322B LN, 325, 325B, 325B L, 561M, 928G, 938F, 950F, 950F II, 950G, 953C, 960F, 963B, CP-563, CS-531C, CS-533C, CS-563C, CS-563D, CS-573C, CS-573D, CS-583C, CS-583D, D5M
7C6973	MAIN BEARING	.75MM / 0.030IN	3116	120H, 213B, 320 L, 320B, 322B LN, 325, 325B, 325B L, 561M, 928G, 938F, 950F, 950F II, 953C, 960F, 963B, CP-563, CS-531C, CS-533C, CS-563C, CS-563D, CS-573C, CS-573D, CS-583C, CS-583D, D5M, D6M
7E7723	MAIN BEARING	.50MM / 0.020IN	3176, 3176B	75, 75C, 85C, R1700 II
7E7727	MAIN BEARING	.50MM / 0.020IN	3176, 3176B	75, 75C, 85C, R1700 II
7H4448	MAIN BEARING (CENTER)	.63MM / 0.025IN	D342, D342C	583H, D8H
7H4449	MAIN BEARING (REAR)	1.25MM / 0.050IN	D342, D342C	583H, D8H
7S9845	MAIN BEARING	.50MM / 0.020IN	D333, 3306, 1673	D4, D5, D6 44A
7S9846	MAIN BEARING	.75MM / 0.030IN	D333, 3306, 1673	D4, D5, D6 44A
8N5341	MAIN BEARING (REAR)	.63MM / 0.025IN	D343, G343	769B
8N5342	MAIN BEARING	1.25MM / 0.050IN	D343, G343	1693, 769B
8N5346	MAIN BEARING	.63MM / 0.025IN	D343, G343	1693, 769B

\*\* (ARRIVING EARLY 2022)

\* Other part no. not included in the list are available. Please contact your sales representative if you have any questions. Part Numbers are used for reference purposes only.

## UNDERSIZE MAIN BEARINGS - *Con't.*

Part No.	Description	Undersize	Engine	Application
8N5347	MAIN BEARING	1.25MM / 0.050IN	D343, G343	1693, 769B
8N7764-010	MAIN BEARING	.25MM / 0.010IN	D379B, D398, D398A, D398B, D399, G398, G399	
8N7923-010	MAIN BEARING (INTERMEDIATE)	.25MM / 0.010IN	D379, D398, D399	D7E
8N7923-020	MAIN BEARING (INTERMEDIATE)	.75MM / 0.030IN	D379, D398, D399	D7E
8N7923-030	MAIN BEARING (INTERMEDIATE)	.75MM / 0.030IN	D379, D398, D399	D7E
8N7924	MAIN BEARING	.50MM / 0.020IN	D342	D7E, D8K-H
8N7925	MAIN BEARING	1.25MM / 0.050IN	D342	D7E, D8K-H
8N8225	MAIN BEARING	.25MM / 0.010IN	3306	MACHINE, INDUSTRIAL
8N8226	MAIN BEARING	.50MM / 0.020IN	3306	MACHINE, INDUSTRIAL
8N8227	MAIN BEARING	.75MM / 0.030IN	3306	MACHINE, INDUSTRIAL
8N8227-040	MAIN BEARING	1.00MM / 0.040IN	3306	MACHINE, INDUSTRIAL
8N8227-050	MAIN BEARING	1.25MM / 0.050IN	3306	MACHINE, INDUSTRIAL
8N8227-060	MAIN BEARING	1.50MM / 0.060IN	3306	MACHINE, INDUSTRIAL
8N8926	MAIN BEARING	.25MM / 0.010IN	3208, 3208T	MACHINE, INDUSTRIAL
8N8972	MAIN BEARING-NON GROOVED (FRONT)	.50MM / 0.020IN	3208, 3208T	MACHINE, INDUSTRIAL
8N8972-030	MAIN BEARING	.75MM / 0.030IN	3208, 3208T	MACHINE, INDUSTRIAL
8N8972-040	MAIN BEARING	1.00MM / 0.040IN	3208, 3208T	MACHINE, INDUSTRIAL
8N8974	MAIN BEARING-NON GROOVED (FRONT)	1.25MM / 0.050IN	3208, 3208T	MACHINE, INDUSTRIAL
8N8976	MAIN BEARING-NON GROOVED (FRONT)	.25MM / 0.010IN	3208, 3208T	MACHINE, INDUSTRIAL
8N9020	MAIN BEARING (INTERMEDIATE)	1.25MM / 0.050IN	3208, 3208T	MACHINE, INDUSTRIAL
8N9022	MAIN BEARING (INTERMEDIATE)	.25MM / 0.010IN	3208, 3208T	MACHINE, INDUSTRIAL
8N9023	MAIN BEARING (INTERMEDIATE)	.50MM / 0.020IN	3208, 3208T	MACHINE, INDUSTRIAL
8N9023-030	MAIN BEARING	.75MM / 0.030IN	3208, 3208T	MACHINE, INDUSTRIAL
8N9023-040	MAIN BEARING	1.00MM / 0.040IN	3208, 3208T	MACHINE, INDUSTRIAL
9M3896-010	MAIN BEARING	.25MM / 0.010IN	D353C	D9G
9M4878	MAIN BEARING (INTERMEDIATE)	1.25MM / 0.050IN	D353C, G353D	GENERATOR, INDUSTRIAL
9M4879	MAIN BEARING (CENTER)	1.25MM / 0.050IN	D353C, G353D	GENERATOR, INDUSTRIAL

\*\* (ARRIVING EARLY 2022)

\* Other part no. not included in the list are available. Please contact your sales representative if you have any questions. Part Numbers are used for reference purposes only.

# OVERSIZED CRANKSHAFT THRUST PLATE / WASHER

Part No.	Description	Undersize	Engine	Application
1039289	PLATE-THRUST	0.15MM OS	C3.4	236B, 236B3, 242B3, 246C, 252B, 252B3, 256C, 257B3, 259B3, 262C, 262C2, 267B, 268B, 272C, 277C, 277C2, 279C, 279C2, 287C, 287C2, 289C, 289C2, 297C, 299C, 3044C, 315, 315B, 315C, 317B LN, 318B, 906
1039290	PLATE-THRUST	0.30MM OS	C3.4	236B, 236B3, 242B3, 246C, 252B, 252B3, 256C, 257B3, 259B3, 262C, 262C2, 267B, 268B, 272C, 277C, 277C2, 279C, 279C2, 287C, 287C2, 289C, 289C2, 297C, 299C, 3044C, 315, 315B, 315C, 317B LN, 318B, 906
0676874	WASHER-THRUST	0.18-MM OS	3054, 3054B, 3054C, 3054E, 3056, 3056E	206, 212, 214, 224, 307, 312, 312B L, 312C, 312D2, 312D2 GC, 312D2 L, 313D2, 313D2 LGP, 315, 315B L, 315C, 317, 318D2 L, 414E, 416B, 416C, 416D, 416E, 416F
2295153	MAIN BEARING (THRUST)	.25MM / 0.010IN	3114, 3116, 3126, 3126B, 3126E	120H, 120H ES, 120H NA, 120K, 120K 2, 12K, 12M, 135H, 135H NA, 140G, 140K, 140K 2, 140M, 160K, 214B, 30/30, 320B, 322B L, 322B LN, 322C, 322C FM, 324D, 324D FM, 324D FM
2295154	MAIN BEARING (THRUST)	.50MM / 0.020IN	3114, 3116, 3126, 3126B, 3126E	120H, 120H ES, 120H NA, 120K, 120K 2, 12K, 12M, 135H, 135H NA, 140G, 140K, 140K 2, 140M, 160K, 214B, 30/30, 320B, 322B L, 322B LN, 322C, 322C FM, 324D, 324D FM, 324D FM
4W8091-030	MAIN BEARING (THRUST)	.75MM / 0.030IN	3208	613C, PR-1000, PS-500
4W8091-040	MAIN BEARING (THRUST)	1.00MM / 0.040IN	3208	613C, PR-1000, PS-500
517787	PLATE-THRUST	0.15-MM OS	3066	311, 311B, 311C, 311D LRR, 312, 312B, 312C, 312C L, 312D, 312D L, 313D, 314C, 314D CR, 314D LCR, 315D L, 318C, 318D L, 319C, 319D, 319D L, 319D LN, 320, 320 L, 320B, 320C, 320C FM, 320C L, 320D, 320D
517788	PLATE-THRUST	0.30-MM OS	3066	311, 311B, 311C, 311D LRR, 312, 312B, 312C, 312C L, 312D, 312D L, 313D, 314C, 314D CR, 314D LCR, 315D L, 318C, 318D L, 319C, 319D, 319D L, 319D LN, 320, 320 L, 320B, 320C, 320C FM, 320C L, 320D, 320D
517789	PLATE-THRUST	0.45-MM OS	3066	311, 311B, 311C, 311D LRR, 312, 312B, 312C, 312C L, 312D, 312D L, 313D, 314C, 314D CR, 314D LCR, 315D L, 318C, 318D L, 319C, 319D, 319D L, 319D LN, 320, 320 L, 320B, 320C, 320C FM, 320C L, 320D, 320D
7C6968	MAIN BEARING (THRUST)	.75MM / 0.030IN	3116	120H, 213B, 320 L, 320B, 322B LN, 325, 325 LN, 325B, 325B L, 561M, 924F, 928G, 938F, 950F, 950F II, 950G, 953C, 960F, 963B, CP-563, CS-531C, CS-533C, CS-563C, CS-563D, CS-573C, CS-573D, CS-583C
7S9844	MAIN BEARING (THRUST)	.25MM / 0.010IN	3306	120B, 140B, D6D, 966C
8N7929	MAIN BEARING (THRUST)	.63MM / 0.025IN	D342	D7E, D8K-H
8N7930	MAIN BEARING (THRUST)	1.25MM / 0.050IN	D342	D7E, D8K-H
8N9064	MAIN BEARING (THRUST)	.50MM / 0.020IN	3208, 3208T	MACHINE, INDUSTRIAL
8N9065	MAIN BEARING (THRUST)	.25MM / 0.010IN	3208, 3208T	MACHINE, INDUSTRIAL
8N9066	MAIN BEARING (THRUST)	1.25MM / 0.050IN	3208, 3208T	MACHINE, INDUSTRIAL

## CRANKSHAFT BUSHINGS (front main bushing)

Part No.	Description	Undersize	Engine	Application
3024181	MAIN BUSHING (CRANKSHAFT)	.25MM / 0.010IN	3013, 3013C, 3014, 3024, 3024C	216, 216B, 216B3, 226B, 226B3, 232B, 242B, 247B, 247B3, 257B, 304.5, AP-255E, BB-621C, C1.1, C1.5, C2.2, CB-214E, CB-22, CB-334D, CB-334E, CB-335D, CB-34, CB22B, CB24B
3024182	MAIN BUSHING (CRANKSHAFT)	.50MM / 0.020IN	3013, 3013C, 3014, 3024, 3024C	216, 216B, 216B3, 226B, 226B3, 232B, 242B, 247B, 247B3, 257B, 304.5, AP-255E, BB-621C, C1.1, C1.5, C2.2, CB-214E, CB-22, CB-334D, CB-334E, CB-335D, CB-34, CB22B, CB24B

\*\* (ARRIVING EARLY 2022)

\* Other part no. not included in the list are available. Please contact your sales representative if you have any questions. Part Numbers are used for reference purposes only.

# UNDERSIZE CONNECTING ROD BEARINGS

Part No.	Description	Undersize	Engine	Application
4393373	CONNECTING ROD BEARING KIT	.25MM / 0.010IN	C2.2	226D, 232D, 239D, 249D,
0332382	CONNECTING ROD BEARING KIT	.25MM / 0.010IN	3054	416C, 428C
0332383	CONNECTING ROD BEARING KIT	.50MM / 0.020IN	3054	416C, 428C
0332384	CONNECTING ROD BEARING KIT	.75MM / 0.030IN	3054	416C, 428C
1039684	CONNECTING ROD BEARING	.25MM / 0.010IN	3046	315, 315B, 315C, 317B LN, 318B, 933, 933C, 939, 939C, D3C III, D3G, D4C III, D4G, D5C III, D5G
1039685	CONNECTING ROD BEARING	.50MM / 0.020IN	3046	315, 315B, 315C, 317B LN, 318B, 933, 933C, 939, 939C, D3C III, D3G, D4C III, D4G, D5C III, D5G
1039686	CONNECTING ROD BEARING	.75MM / 0.030IN	3046	315, 315B, 315C, 317B LN, 318B, 933, 933C, 939, 939C, D3C III, D3G, D4C III, D4G, D5C III, D5G
1077331	CONNECTING ROD BEARING	.25MM / 0.010IN	3508, 3508B, 3508C, 3512, 3512B, 3512C, 3516, 3516B, 3516C	5130, 5130B, 5230, 5230B, 776C, 776D, 777, 777B, 777C, 777D, 784B, 784C, 785, 785B, 785C, 789, 789B, 789C, 789D, 793B, 793C, 793D, 797, 797B
1077332	CONNECTING ROD BEARING	.50MM / 0.020IN	3508, 3508B, 3508C, 3512, 3512B, 3512C, 3516, 3516B, 3516C	5130, 5130B, 5230, 5230B, 776C, 776D, 777, 777B, 777C, 777D, 784B, 784C, 785, 785B, 785C, 789, 789B, 789C, 789D, 793B, 793C, 793D, 797, 797B
1280390	CONNECTING ROD BEARING	.50MM / 0.020IN	3176C	140H, 143H, 14H, 160H, 163H, 345B, 345B II, 345B II MH, 345B L, 480, 572R II, 65E, 725, 75D, 75E, 814F, 815F, 816F, 966G II, C-10, CPT372, D7R II, R1600G, TK1051, W345B II
1280391	CONNECTING ROD BEARING	.75MM / 0.030IN	3176C	140H, 143H, 14H, 160H, 163H, 345B, 345B II, 345B II MH, 345B L, 480, 572R II, 65E, 725, 75D, 75E, 814F, 815F, 816F, 966G II, C-10, CPT372, D7R II, R1600G, TK1051, W345B II
1280395	CONNECTING ROD BEARING	.50MM / 0.020IN	3176B, 3176C, 3196, C-12, C11, C12, C13	14M, 16H, 16M, 345C, 345C L, 345C MH, 345D, 345D L, 345D L VG, 349D, 349D L, 365B, 365B II, 365B L, 725, 730, 730C, 85D, 85E, 95E, 966H, 972G II, 972H, 980C
1280396	CONNECTING ROD BEARING	.75MM / 0.030IN	3176B, 3176C, 3196, C-12, C11, C12, C13	14M, 16H, 16M, 345C, 345C L, 345C MH, 345D, 345D L, 345D L VG, 349D, 349D L, 365B, 365B II, 365B L, 725, 730, 730C, 85D, 85E, 95E, 966H, 972G II, 972H, 980C
1N3821	CONNECTING ROD BEARING	.25MM / 0.010IN	3204	215, 931B, 943, 953, D3, D4HTSK II, D5C
1N3822	CONNECTING ROD BEARING	.50MM / 0.020IN	3204	215, 931B, 943, 953, D3, D4HTSK II, D5C
1N3822-030	CONNECTING ROD BEARING	.75MM / 0.030IN	3204	215, 931B, 943, 953, D3, D4HTSK II, D5C
1N4336-010	CONNECTING ROD BEARING	.25MM / 0.010IN	D353	D9, D9E, D9G, 594
1N4337	CONNECTING ROD BEARING	.63MM / 0.025IN	D353	D9, D9E, D9G, 594
1N4338	CONNECTING ROD BEARING	1.25MM / 0.050IN	D353	D9, D9E, D9G, 594
1W3906	CONNECTING ROD BEARING	1.25MM / 0.050IN	3204	215, 931B, 943, 953, D3, D4HTSK II, D5C
2323235	CONNECTING ROD BEARING	.63MM / 0.025IN	3406E, C15, C18	24M, 365C, 365C L, 365C L MH, 374D L, 374F L, 385C, 385C FS, 385C L, 385C L MH, 390D, 390D L, 583T, 587T, 621B, 621F, 621G, 621H, 623E, 623F, 623G, 623H, 627F, 627G, 627H, 631D, 631E, 631G, 633E II

\*\* (ARRIVING EARLY 2022)

\* Other part no. not included in the list are available. Please contact your sales representative if you have any questions. Part Numbers are used for reference purposes only.

## UNDERSIZE CONNECTING ROD BEARINGS - Con't.

Part No.	Description	Undersize	Engine	Application
2323236	CONNECTING ROD BEARING	1.25MM / 0.050IN	3406E, C15, C18	24M, 365C, 365C L, 365C L MH, 374D L, 374F L, 385C, 385C FS, 385C L, 385C L MH, 390D, 390D L, 583T, 587T, 621B, 621F, 621G, 621H, 623E, 623F, 623G, 623H, 627F, 627G, 627H, 631D, 631E, 631G, 633E II
2333788	CONNECTING ROD BEARING KIT	.25MM / 0.010IN	3054C, 3054E	315C, 414E, 416D, 416E, 420D, 420E, 422E, 424D, 428D, 428E, 430D, 432D, 432E, 434E, 442D, 914G, AP-650B, AP-800D, C4.4, CB-534D, CB-564D, CD-54, CP-433E, CS-433E, CS-533E, IT14G, M313C
2333789	CONNECTING ROD BEARING KIT	.50MM / 0.020IN	3054C, 3054E	315C, 414E, 416D, 416E, 420D, 420E, 422E, 424D, 428D, 428E, 430D, 432D, 432E, 434E, 442D, 914G, AP-650B, AP-800D, C4.4, CB-534D, CB-564D, CD-54, CP-433E, CS-433E, CS-533E, IT14G, M313C
2388283	CONNECTING ROD BEARING KIT	.25MM / 0.010IN	3044C	236B, 236B3, 242B3, 246C, 252B, 252B3, 256C, 257B3, 259B3, 262C, 262C2, 267B, 268B, 272C, 277C, 277C2, 279C, 279C2, 287C, 287C2, 289C, 289C2, 297C, 299C, 303C CR, 304C CR, 305.5D, 305C CR, 305D
2388284	CONNECTING ROD BEARING KIT	.50MM / 0.020IN	3044C	236B, 236B3, 242B3, 246C, 252B, 252B3, 256C, 257B3, 259B3, 262C, 262C2, 267B, 268B, 272C, 277C, 277C2, 279C, 279C2, 287C, 287C2, 289C, 289C2, 297C, 299C, 303C CR, 304C CR, 305.5D, 305C CR, 305D
2822478	CONNECTING ROD BEARING	.25MM / 0.010IN	C9	12H, 12M 2, 12M 3, 12M 3 AWD, 140M, 140M 2, 140M 3, 140M 3 AWD, 160M, 160M 2, 160M 3, 160M 3 AWD, 2864C, 330C, 330C FM, 330C L, 330C MH, 330D, 330D FM, 330D L, 330D LN, 330D MH, 336D, 336D L, 336D LN
2822479	CONNECTING ROD BEARING	.50MM / 0.020IN	C9	12H, 12M 2, 12M 3, 12M 3 AWD, 140M, 140M 2, 140M 3, 140M 3 AWD, 160M, 160M 2, 160M 3, 160M 3 AWD, 2864C, 330C, 330C FM, 330C L, 330C MH, 330D, 330D FM, 330D L, 330D LN, 330D MH, 336D, 336D L, 336D LN
2977648	CONNECTING ROD BEARING	.25MM / 0.010IN	C4.2	311D LRR, 312D, 312D L, 313D, 314D CR, 314D LCR, 315D L, 318D L, 319D, 319D L, 319D LN, 320D, 320D FM, 320D FM RR, 320D GC, 320D L, 320D LN, 320D LRR, 320D RR, 321D LCR, 323D L, 323D LN, 323D SA
2977649	CONNECTING ROD BEARING	.50MM / 0.020IN	C4.2	311D LRR, 312D, 312D L, 313D, 314D CR, 314D LCR, 315D L, 318D L, 319D, 319D L, 319D LN, 320D, 320D FM, 320D FM RR, 320D GC, 320D L, 320D LN, 320D LRR, 320D RR, 321D LCR, 323D L, 323D LN, 323D SA
2M6499-010	CONNECTING ROD BEARING	.25MM / 0.010IN	D342, D342C, G342C	D8H
2M6500	CONNECTING ROD BEARING	.25MM / 0.010IN	D342, D342C, G342C	D8H
2M6501	CONNECTING ROD BEARING	.50MM / 0.020IN	D342, D342C, G342C	D8H
3079855	CONNECTING ROD BEARING KIT	.25MM / 0.010IN	3014, 3024, 3024C	216, 216B, 226B, 232B, 242B, 247B, 257B, 304.5, C2.2, CB-334E
3079856	CONNECTING ROD BEARING KIT	.50MM / 0.020IN	3014, 3024, 3024C	216, 216B, 226B, 232B, 242B, 247B, 257B, 304.5, C2.2, CB-334E
3410060	CONNECTING ROD BEARING	.63MM / 0.025IN	C27, C32	3412D, 773F, 773G, 773G LRC, 775F, 775G, 775G LRC, 775G OEM, 777C, 777D, 777F, 777G, 844H, 844K, 854K, 990H, 990K, 992K, 993K, AD55B, AD60, D10N, D10R, D10T, D10T2, D11R, D11T

\*\* (ARRIVING EARLY 2022)

\* Other part no. not included in the list are available. Please contact your sales representative if you have any questions. Part Numbers are used for reference purposes only.

## UNDERSIZE CONNECTING ROD BEARINGS - Con't.

Part No.	Description	Undersize	Engine	Application
4587918	CONNECTING ROD BEARING KIT	.25MM / 0.010IN	C6.6, C7.1	AP-100F, AP-1055F, 815, 816, 816K
4587939	CONNECTING ROD BEARING KIT	.50MM / 0.020IN	C6.6, C7.1	AP-100F, AP-1055F, 815, 816, 816K
4587940	CONNECTING ROD BEARING KIT	.75MM / 0.030IN	C6.6, C7.1	120M, 120M 2, 12M, 2384C, 2470C, 2484C, 2570C, 2670C, 320D GC, 320D L, 320D2, 320D2 GC, 320D2 L, 320E, 320E L, 320E LN, 320E LRR, 320E RR, 323D L, 323D2 L, 323E L, 324E, 324E L, 324E LN, 329E, 329E L
4687770	CONNECTING ROD BEARING KIT	.75MM / 0.030IN	C4.4	
4P9945	CONNECTING ROD BEARING KIT	.25MM / 0.010IN	3054B	416B, 416C, 416D, 420D, 424D, 426C, 428C, 428D, 430D, 432D, 436C, 438C, 438D, 442D, BG-225B, CB-534B, CP-433C, CS-431C, PS-300B, TH83
4P9946	CONNECTING ROD BEARING KIT	.50MM / 0.020IN	3054B	416B, 416C, 416D, 420D, 424D, 426C, 428C, 428D, 430D, 432D, 436C, 438C, 438D, 442D, BG-225B, CB-534B, CP-433C, CS-431C, PS-300B, TH83
4P9947	CONNECTING ROD BEARING KIT	.75MM / 0.030IN	3054B	416B, 416C, 416D, 420D, 424D, 426C, 428C, 428D, 430D, 432D, 436C, 438C, 438D, 442D, BG-225B, CB-534B, CP-433C, CS-431C, PS-300B, TH83
4W5693	CONNECTING ROD BEARING	.63MM / 0.025IN	D348	777
4W5694	CONNECTING ROD BEARING	1.25MM / 0.050IN	D348	777
4W5697	CONNECTING ROD BEARING	1.25MM / 0.050IN	D348	777
4W5702	CONNECTING ROD BEARING	.63MM / 0.025IN	3406, 3406B, 3406C, 3408, 3408B, 3408C, 3408E, 3412, 3412C, 3412E	16G, 245, 24H, 5110B, 578, 589, 621E, 623E, 627E, 631D, 631E, 631G, 633E II, 637D, 637E, 637G, 651E, 657E, 769C, 769D, 771C, 771D
4W5702-030	CONNECTING ROD BEARING	.75MM / 0.030IN	3406, 3406B, 3406C, 3408, 3408B, 3408C, 3408E, 3412, 3412C, 3412E	16G, 245, 24H, 5110B, 578, 589, 621E, 623E, 627E, 631D, 631E, 631G, 633E II, 637D, 637E, 637G, 651E, 657E, 769C, 769D, 771C, 771D
4W5703	CONNECTING ROD BEARING	1.25MM / 0.050IN	3406, 3406B, 3406C, 3408, 3408B, 3408C, 3408E, 3412, 3412C, 3412E	16G, 245, 24H, 5110B, 578, 589, 621E, 623E, 627E, 631D, 631E, 631G, 633E II, 637D, 637E, 637G, 651E, 657E, 769C, 769D, 771C, 771D
5I7795	CONNECTING ROD BEARING	.50MM / 0.020IN	3066	311, 311B, 311C, 312B, 312C, 312C L, 314C, 318C, 319C, 320 L, 320B, 320C, 320C FM, 320C L, 320D, 320D LRR, 321C, 323D L, 323D LN
5I7796	CONNECTING ROD BEARING	.75MM / 0.030IN	3066	311, 311B, 311C, 312B, 312C, 312C L, 314C, 318C, 319C, 320 L, 320B, 320C, 320C FM, 320C L, 320D, 320D LRR, 321C, 323D L, 323D LN
6207-37-3600	CONNECTING ROD BEARING KOMATSU®	.75MM / 0.030IN	S4D95L, S6D95L, SA6D95L, SAA6D95LE	
6207-38-3600	CONNECTING ROD BEARING KOMATSU®	.50MM / 0.020IN	S4D95L, S6D95L, SA6D95L, SAA6D95LE	
6207-39-3600	CONNECTING ROD BEARING KOMATSU®	.25MM / 0.010IN	S4D95L, S6D95L, SA6D95L, SAA6D95LE	
6210-37-3041	CONNECTING ROD BEARING KOMATSU®	.75MM / 0.030IN	S6D140, SA6D132, SA6D140, SA6D140A	HM350, HM400

\*\* (ARRIVING EARLY 2022)

\* Other part no. not included in the list are available. Please contact your sales representative if you have any questions. Part Numbers are used for reference purposes only.

## UNDERSIZE CONNECTING ROD BEARINGS - Con't.

Part No.	Description	Undersize	Engine	Application
6754-32-3420	CONNECTING ROD BEARING KOMATSU®	.75MM / 0.030IN	SA6102-1AC, SAA4D107E, SAA6D102E, SAA6D107E,	PC200, PC200LL, PC220, PC220LL, PC240, PC270, PC290, WA250, WA320, WA380
7C6976	CONNECTING ROD BEARING	.25MM / 0.010IN	3114, 3116	120H, 120H ES, 120H NA, 120K, 120K 2, 12K, 12M, 135H, 135H NA, 140G, 140K, 140K 2, 140M, 160K, 211B, 214B, 30/30, 3126, 3126B, 3126E, 320 L, 320B, 322B L, 322B LN, 322C, 322C FM, 324D
7C6977	CONNECTING ROD BEARING	.50MM / 0.020IN	3114, 3116, 3126, 3126B, 3126E	120H, 120H ES, 120H NA, 120K, 120K 2, 12K, 12M, 135H, 135H NA, 140G, 140K, 140K 2, 140M, 160K, 211B, 214B, 30/30, 320 L, 320B, 322B L, 322B LN, 322C, 322C FM, 324D, 324
7C6978	CONNECTING ROD BEARING	.75MM / 0.030IN	3116	214B, 320 L, 918F, E200B, E240C
7E0558	CONNECTING ROD BEARING	.63MM / 0.025IN	3406, 3406B, 3406C, 3406E, 3456	16G, 16H NA, 245B, 375, 375 L, 385B, 5080, 5090B, 578, 583R, 587R, 621E, 621F, 621G, 623E, 623F, 623G, 627B, 627E, 627F, 627G, 651B, 657B, 735, 740, 814B, 824C, 824G
7E0559	CONNECTING ROD BEARING	1.25MM / 0.050IN	3406, 3406B, 3406C, 3406E, 3456	16G, 16H NA, 245B, 375, 375 L, 385B, 5080, 5090B, 578, 583R, 587R, 621E, 621F, 621G, 623E, 623F, 623G, 627B, 627E, 627F, 627G, 651B, 657B, 735, 740, 814B, 824C, 824G
7E7721	CONNECTING ROD BEARING	.50MM / 0.020IN	3176, 3176B	75, 75C, 85C, R1700 II
7N2583	CONNECTING ROD BEARING	1.25MM / 0.050IN	D348	992
7W2136-010	CONNECTING ROD BEARING	.25MM / 0.010IN	D340, D343, 1693	D4, D5, D6 44A
7W2136-020	CONNECTING ROD BEARING	.50MM / 0.020IN	D340, D343, 1693	16, 619C, 768B, 769B, 983, 824B, 834, 631C
7W2136-030	CONNECTING ROD BEARING	.75MM / 0.030IN	D340, D343, 1693	16, 619C, 768B, 769B, 983, 824B, 834, 631C
7W4817	CONNECTING ROD BEARING	.25MM / 0.010IN	3056, 3056E	214, 224, 550B, 560B, 564, 574B, 924G, 924GZ, 930G, AP-655C, BB-760, CP-573E, CP-663E, CS-563E, CS-583E, CS-663E, CS-683E, IT28G, M316C, M318C, M318C MH, M322C
7W4819	CONNECTING ROD BEARING	.75MM / 0.030IN	3056, 3056E	214, 224, 550B, 560B, 564, 574B, 924G, 924GZ, 930G, AP-655C, BB-760, CP-573E, CP-663E, CS-563E, CS-583E, CS-663E, CS-683E, IT28G, M316C, M318C, M318C MH, M322C
8N5339	CONNECTING ROD BEARING	.63MM / 0.025IN	D343, G343	619C
8N5436	CONNECTING ROD BEARING	1.25MM / 0.050IN	3406	16G, 245, D3, 621B,
8N6308-040	CONNECTING ROD BEARING	1.00MM / 0.040IN	3204	215, 931B, 943, 953, D3, D4HTSK II, D5C
8N7770	CONNECTING ROD BEARING	.63MM / 0.025IN	D379, D379B, D398B, G379, G398, G399	
8N7771	CONNECTING ROD BEARING	1.25MM / 0.050IN	D379B, G398, G399	GENERATOR, INDUSTRIAL
8N7933-010	CONNECTING ROD BEARING	.25MM / 0.010IN	D339	D6600, D7700, D8800, D8841
8N7933-020	CONNECTING ROD BEARING	.50MM / 0.020IN	D339	D6600, D7700, D8800, D8841
8N7933-030	CONNECTING ROD BEARING	.75MM / 0.030IN	D339	D6600, D7700, D8800, D8841

\*\* (ARRIVING EARLY 2022)

\* Other part no. not included in the list are available. Please contact your sales representative if you have any questions. Part Numbers are used for reference purposes only.

## UNDERSIZE CONNECTING ROD BEARINGS - Con't.

Part No.	Description	Undersize	Engine	Application
8N7933-040	CONNECTING ROD BEARING	1.00MM / 0.040IN	D339	D6600, D7700, D8800, D8841
8N7934	CONNECTING ROD BEARING	.63MM / 0.025IN	D339	D6600, D7700, D8800, D8841
8N7935	CONNECTING ROD BEARING	1.25MM / 0.050IN	D339	D6600, D7700, D8800, D8841
8N8221	CONNECTING ROD BEARING	.25MM / 0.010IN	3304, 3304B, 3306, 3306B, 3306C	120G, 12G, 12H, 12H ES, 12H NA, 130G, 140G, 140H, 140H ES, 140H NA, 143H, 14G, 14H NA, 160G, 160H, 160H ES, 160H NA, 163H NA, 1673C, 235, 235B, 330, 330 FM L, 330 L
8N8222	CONNECTING ROD BEARING	.50MM / 0.020IN	3304, 3304B, 3306, 3306B, 3306C	120G, 12G, 12H, 12H ES, 12H NA, 130G, 140G, 140H, 140H ES, 140H NA, 143H, 14G, 14H NA, 160G, 160H, 160H ES, 160H NA, 163H NA, 1673C, 235, 235B, 330, 330 FM L, 330 L
8N8223	CONNECTING ROD BEARING	.75MM / 0.030IN	3304, 3304B, 3306, 3306B, 3306C	120G, 12G, 12H, 12H ES, 12H NA, 130G, 140G, 140H, 140H ES, 140H NA, 143H, 14G, 14H NA, 160G, 160H, 160H ES, 160H NA, 163H NA, 1673C, 235, 235B, 330, 330 FM L, 330 L
8N8223-040	CONNECTING ROD BEARING	1.00MM / 0.040IN	3304, 3304B, 3306, 3306B, 3306C	120G, 12G, 12H, 12H ES, 12H NA, 130G, 140G, 140H, 140H ES, 140H NA, 143H, 14G, 14H NA, 160G, 160H, 160H ES, 160H NA, 163H NA, 1673C, 235, 235B, 330, 330 FM L, 330 L
8N8223-050	CONNECTING ROD BEARING	1.25MM / 0.050IN	3304, 3304B, 3306, 3306B, 3306C	120G, 12G, 12H, 12H ES, 12H NA, 130G, 140G, 140H, 140H ES, 140H NA, 143H, 14G, 14H NA, 160G, 160H, 160H ES, 160H NA, 163H NA, 1673C, 235, 235B, 330, 330 FM L, 330 L
8N8223-060	CONNECTING ROD BEARING	1.50MM / 0.060IN	3304, 3304B, 3306, 3306B, 3306C	120G, 12G, 12H, 12H ES, 12H NA, 130G, 140G, 140H, 140H ES, 140H NA, 143H, 14G, 14H NA, 160G, 160H, 160H ES, 160H NA, 163H NA, 1673C, 235, 235B, 330, 330 FM L, 330 L
9F8580-010	CONNECTING ROD BEARING	.25MM / 0.010IN	D315	955C, 977D
9F8580-020	CONNECTING ROD BEARING	.50MM / 0.020IN	D315	955C, 977D
9F8581	CONNECTING ROD BEARING	.75MM / 0.030IN	D315	955C, 977D
9F8581-050	CONNECTING ROD BEARING	1.25MM / 0.050IN	D315	955C, 977D
9N5920	CONNECTING ROD BEARING	.25MM / 0.010IN	3208	225, 227, 613B, 613C, FB221, PR-1000, PS-500
9N5921	CONNECTING ROD BEARING	.50MM / 0.020IN	3208T, 3208	225, 225B, 225D, 229, 231D, CB-614, CP-533, CS-553, PS-500, 613B. 613C
9N5921-030	CONNECTING ROD BEARING	.75MM / 0.030IN	3208T, 3208	225, 225B, 225D, 229, 231D, CB-614, CP-533, CS-553, PS-500, 613B. 613C
9N5921-040	CONNECTING ROD BEARING	1.00MM / 0.040IN	3208T, 3208	225, 225B, 225D, 229, 231D, CB-614, CP-533, CS-553, PS-500, 613B. 613C
9N5922	CONNECTING ROD BEARING	1.25MM / 0.050IN	3208T, 3208	225, 227
9N5924	CONNECTING ROD BEARING	.25MM / 0.010IN	3208	INDUSTRIAL, MARINE
9N5925	CONNECTING ROD BEARING	.50MM / 0.020IN	3208	INDUSTRIAL, MARINE
9N5926	CONNECTING ROD BEARING	1.25MM / 0.050IN	3208	INDUSTRIAL, MARINE

\*\* (ARRIVING EARLY 2022)

\* Other part no. not included in the list are available. Please contact your sales representative if you have any questions. Part Numbers are used for reference purposes only.



## UNDERSIZE CONNECTING ROD BEARINGS - *Con't.*

Part No.	Description	Undersize	Engine	Application
9Y6190	CONNECTING ROD BEARING KIT	1.25MM / 0.050IN	3406B, 3408, 3408B, 3408C, 3408E, 3412, 3412C, 3412E	24H, 5110B, 589, 631D, 631E, 631G, 633E II, 637E, 637G, 651E, 657E, 69D, 769C, 769D, 771C, 771D, 773B, 773D, 773E, 775B, 775D, 775E, 834B, 836
9Y7735-010	CONNECTING ROD BEARING	.25MM / 0.010IN	3406, 3406B, 3406C, 3406E, G3406	16G, 16H NA, 245B, 375, 375 L, 5080, 578, 621E, 621F, 623E, 627E, 627F, 826C, 980C, 980F, 980G, 980G II, C-15, CB-614, D350E II, D400E II, D8N, R2900, RR-250, SS-250
9Y9497-010	CONNECTING ROD BEARING	.25MM / 0.010IN	3406, 3406B, 3408, 3408B, 3408C, 3408E, 3412, 3412C, 3412E,	16G, 245, 5110B, 578, 589, 621E, 623E, 627E, 631E, 637E, 651E, 657E, 69D, 772B, 775B, 826C, 836, 980C, 988B, 992C, AD40, AD45, AE40, AE40 II
9Y9497-020	CONNECTING ROD BEARING	.50MM / 0.020IN	3406, 3406B, 3408, 3408B, 3408C, 3408E, 3412, 3412C, 3412E,	16G, 245, 5110B, 578, 589, 621E, 623E, 627E, 631E, 637E, 651E, 657E, 69D, 772B, 775B, 826C, 836, 980C, 988B, 992C, AD40, AD45, AE40, AE40 II

## UNDERSIZE & OVERSIZE MAIN BEARINGS

**Undersize** = when the crankshaft has been re-ground "undersize"

**Oversize** = when the cylinder block has been bored to use "Oversize" O.D. bearings

Part No.	Description	Undersize	Oversize	Engine	Application
1280384	MAIN BEARING	STD	.50MM / 0.020IN	3176C, 3196	140H, 143H, 14H, 14M, 160H, 163H, 16H, 16M, 345B, 345B II, 345B II MH, 345B L, 345C, 345C L, 345C MH, 345D, 345D L, 345D L VG, 349D, 349D L, 349E, 349E L, 349E L HVG, 349E L VG, 349F L
1280385	MAIN BEARING	.50MM / 0.020IN	.50MM / 0.020IN	3176C, 3196	140H, 143H, 14H, 14M, 160H, 163H, 16H, 16M, 345B, 345B II, 345B II MH, 345B L, 345C, 345C L, 345C MH, 345D, 345D L, 345D L VG, 349D, 349D L, 349E, 349E L, 349E L HVG, 349E L VG, 349F L
1450168	MAIN BEARING	STD	.50MM / 0.020IN	3114, 3116, 3126, 3126B, 3126E	120H, 120H ES, 120H NA, 120K, 120K 2, 12K, 12M, 135H, 135H NA, 140G, 140K, 140K 2, 140M, 160K, 214B, 30/30, 320B, 322B L, 322B LN, 322C, 322C FM, 324D, 324D FM, 324D FM
1450169	MAIN BEARING	STD	.50MM / 0.020IN	3114, 3116, 3126, 3126B, 3126E	120H, 120H ES, 120H NA, 120K, 120K 2, 12K, 12M, 135H, 135H NA, 140G, 140K, 140K 2, 140M, 160K, 214B, 30/30, 320B, 322B L, 322B LN, 322C, 322C FM, 324D, 324D FM, 324D FM
1450170	MAIN BEARING	.50MM / 0.020IN	.50MM / 0.020IN	3114, 3116, 3126, 3126B, 3126E	120H, 120H ES, 120H NA, 120K, 120K 2, 12K, 12M, 135H, 135H NA, 140G, 140K, 140K 2, 140M, 160K, 214B, 30/30, 320B, 322B L, 322B LN, 322C, 322C FM, 324D, 324D FM, 324D FM
1496034	MAIN BEARING	STD	.63MM / 0.025IN	3508, 3508B, 3508C, 3512, 3512B, 3512C, 3516, 3516B, 3516C	5130, 5130B, 5230, 5230B, 776C, 776D, 777, 777B, 777C, 777D, 784C, 785, 785B, 785C, 785D, 789, 789B, 789C, 789D, 793C, 793D, 797, 797B, 854G
1496035	MAIN BEARING	.63MM / 0.025IN	.63MM / 0.025IN	3508, 3508B, 3508C, 3512, 3512B, 3512C, 3516, 3516B, 3516C	5130, 5130B, 5230, 5230B, 776C, 776D, 777, 777B, 777C, 777D, 784C, 785, 785B, 785C, 785D, 789, 789B, 789C, 789D, 793C, 793D, 797, 797B, 854G
1W1664	MAIN BEARING-NON GROOVED	STD	.25MM / 0.010IN	3204	215B, 916, 926, 926A, 931B, 931C, 931C II, 943, 953, D3B, D3C, D3C II, D4C, D4C II, G916, G926, IT18, IT18B, IT28, IT28B
1W1665	MAIN BEARING-GROOVED	.50MM / 0.020IN	.25MM / 0.010IN	3204	INDUSTRIAL

\*\* (ARRIVING EARLY 2022)

\* Other part no. not included in the list are available. Please contact your sales representative if you have any questions. Part Numbers are used for reference purposes only.

## UNDERSIZE & OVERSIZE MAIN BEARINGS - Con't.

Part No.	Description	Undersize	Oversize	Engine	Application
4P7305	MAIN BEARING	STD	.50MM / 0.020IN	3304, 3304B, 3306, 3306B, 3306C	120G, 12G, 12H, 12H ES, 12H NA, 130G, 140B, 140G, 140H, 140H ES, 140H NA, 143H, 14G, 14H NA, 160G, 160H, 160H ES, 160H NA, 163H NA, 1673C, 235, 235B, 330, 330B L, 350
4W5700	MAIN BEARING	.63MM / 0.025IN	.63MM / 0.025IN	3406, 3406B, 3406C, 3406E, 3408, 3408B, 3408C, 3408E, 3412, 3412C, 3412D, 3412E, 3456	16G, 16H NA, 245, 245B, 24H, 24M, 365C, 365C L, 365C L MH, 374D L, 374F L, 375, 375 L, 385B, 385C, 385C FS, 385C
4W5701	MAIN BEARING	.63MM / 0.025IN	.63MM / 0.025IN	3406, 3406B, 3406C, 3406E, 3408, 3408B, 3408C, 3408E, 3412, 3412C, 3412D, 3412E, 3456	16G, 16H NA, 245, 245B, 24H, 24M, 365C, 365C L, 365C L MH, 374D L, 374F L, 375, 375 L, 385B, 385C, 385C FS, 385C
8N5349	MAIN BEARING	.63MM / 0.025IN	.63MM / 0.025IN	D343, G343	1693, 769B
8N7767	MAIN BEARING	STD	.63MM / 0.025IN	D379B, D398, D398A, D398B, D399, G398, G399	
8N7768	MAIN BEARING	.63MM / 0.025IN	.63MM / 0.025IN	D379B, D398, D398A, D398B, D399, G398, G399	
8N7927	MAIN BEARING	.63MM / 0.025IN	.63MM / 0.025IN	D342	D7E, D8K-H
8N8228	MAIN BEARING	STD	.50MM / 0.020IN	3306	MACHINE, INDUSTRIAL
8N8229	MAIN BEARING	.25MM / 0.010IN	.50MM / 0.020IN	3306	MACHINE, INDUSTRIAL
8N8971	MAIN BEARING-NON GROOVED (FRONT)	.50MM / 0.020IN	.25MM / 0.010IN	3208, 3208T	MACHINE, INDUSTRIAL
8N8973	MAIN BEARING	STD	.25MM / 0.010IN	3208, 3208T	MACHINE, INDUSTRIAL
8N8975	MAIN BEARING-NON GROOVED (FRONT)	1.25MM / 0.050IN	.25MM / 0.010IN	3208, 3208T	MACHINE, INDUSTRIAL
8N9018	MAIN BEARING-GROOVED (INTER-MEDIATE)	1.25MM / 0.050IN	.25MM / 0.010IN	3208, 3208T	MACHINE, INDUSTRIAL
8N9019	MAIN BEARING-GROOVED (INTER-MEDIATE)	.50MM / 0.020IN	.25MM / 0.010IN	3208, 3208T	MACHINE, INDUSTRIAL
8N9021	MAIN BEARING-GROOVED (INTER-MEDIATE)	STD	.25MM / 0.010IN	3208, 3208T	MACHINE, INDUSTRIAL
8N9067	MAIN BEARING-GROOVED (THRUST)	STD	.25MM / 0.010IN	3208, 3208T	MACHINE, INDUSTRIAL
8N9068	MAIN BEARING-GROOVED (THRUST)	.50MM / 0.020IN	.25MM / 0.010IN	3208, 3208T	MACHINE, INDUSTRIAL
8N9069	MAIN BEARING-GROOVED (THRUST)	1.25MM / 0.050IN	.25MM / 0.010IN	3208, 3208T	MACHINE, INDUSTRIAL

\*\* (ARRIVING EARLY 2022)

\* Other part no. not included in the list are available. Please contact your sales representative if you have any questions. Part Numbers are used for reference purposes only.

## UNDERSIZE & OVERSIZE CONNECTING ROD BEARINGS

Part No.	Description	Undersize	Oversize	Engine	Application
1077333	CONNECTING ROD BEARING	STD	.25MM / 0.010IN	3508, 3508B, 3508C, 3512, 3512B, 3512C, 3516, 3516B, 3516C	5130, 5130B, 5230, 5230B, 776C, 776D, 777, 777B, 777C, 777D, 784B, 784C, 785, 785B, 785C, 789, 789B, 789C, 789D, 793B, 793C, 793D, 797, 797B
2333790	CONNECTING ROD BEARING	.75MM / 0.030IN	.75MM / 0.030IN	3054C, 3054E	315C, 414E, 416D, 416E, 420D, 420E, 422E, 424D, 428D, 428E, 430D, 432D, 432E, 434E, 442D, 914G, AP-650B, AP-800D, C4.4, CB-534D, CB-564D, CD-54, CP-433E, CS-433E, CS-533E, IT14G, M313C
8N7772	CONNECTING ROD BEARING	STD	.25MM / 0.010IN	D379B, G398, G399	GENERATOR, INDUSTRIAL
8N7773	CONNECTING ROD BEARING	.63MM / 0.025IN	.25MM / 0.010IN	D379B, G398, G399	GENERATOR, INDUSTRIAL
8N7774	CONNECTING ROD BEARING	1.25MM / 0.050IN	.25MM / 0.010IN	D379B, G398, G399	GENERATOR, INDUSTRIAL

## OVERSIZE CAMSHAFT BUSHING

Part No.	Description	Undersize	Oversize	Engine	Application
2170751	CAMSHAFT BUSHING	STD	.25MM / 0.010IN	3406E, 3456	24M, 365C, 365C L, 365C L MH, 374D L, 374F L, 385B, 385C, 385C FS, 385C L, 385C L MH, 390D, 390D L, 390F L, 5090B, 583T, 587T, 621B, 621G, 623G, 627F, 627G, 631D, 631E, 631G, 633E II, 637
2170752	CAMSHAFT BUSHING	STD	.75MM / 0.030IN	3406E, 3456	24M, 365C, 365C L, 365C L MH, 374D L, 374F L, 385B, 385C, 385C FS, 385C L, 385C L MH, 390D, 390D L, 390F L, 5090B, 583T, 587T, 621B, 621G, 623G, 627F, 627G, 631D, 631E, 631G, 633E II, 637

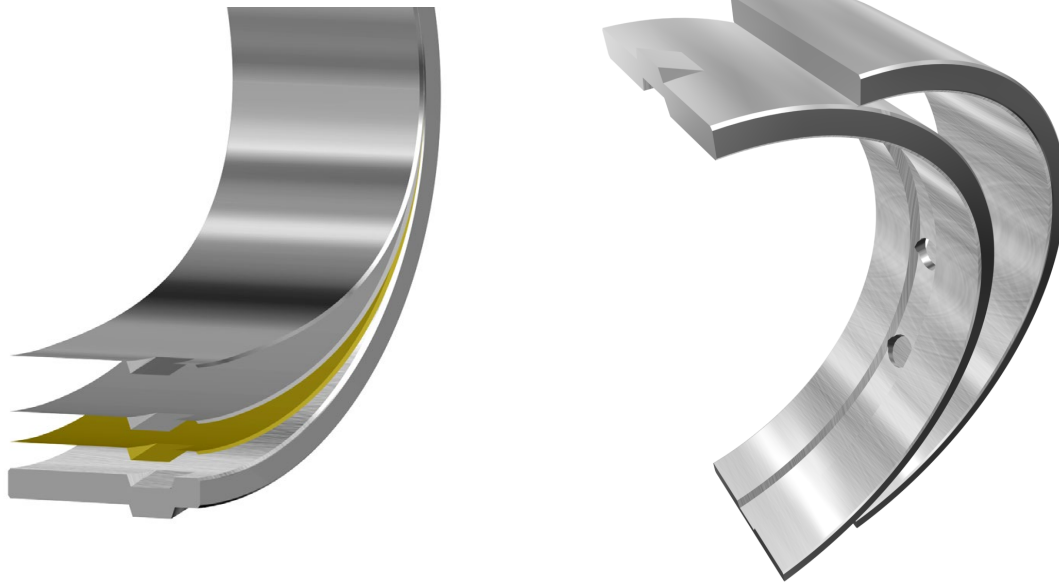

\*\* (ARRIVING EARLY 2022)

\* Other part no. not included in the list are available. Please contact your sales representative if you have any questions. Part Numbers are used for reference purposes only.